

1U Rackmount 17" Wide 1920 x 1200 WUXGA, with 104 key notepad SUN keyboard w/ touch pad (e), with 12-port DVI-D only+ USB+ Audio KVM switch, Audio out x 1, Includes NC-6: 6pc 6ft long DVI +USB+ Audio KVM Cables, 580mm(23 inch) Deep

Model: NW117X-12DSe



FEATURES:

- 1U 17" widescreen LCD console drawer with VGA, DVI-D and HDMI w/ speaker
- 1920 x 1200 native WUXGA Ultra high resolution
- PIP & Picture by Picture viewing efficiency
- 104-key keyboard with either touchpad or trackball
- New enhanced aesthetics with molded front handle
- 2 post rack mounting available
- Short depth design of 580mm(23 inch) Deep
- 12-port DVI-D, USB & Audio KVM
- DVI-D single link support 1920 x 1200 transmission
- Support widescreen & native SUN 1152 x 900 resolution
- Multi-platform for PCs, SUN and Mac G3 / G4 Mac / iMac
- Hot pluggable, no software or drivers required

SPECIFICATIONS:

| | |
|---------------------------------------|---|
| LCD Panel | |
| Diagonal size | 17" widescreen TFT |
| Max. Resolution | 1920 x 1200 |
| Brightness (cd/m2) | 210 |
| Backlight | LED |
| Colors | 16.7 M, 8-bit |
| Contrast Ratio (typ) | 600 : 1 |
| Viewing Angle (H/V) | 130° x 110° |
| Active area (mm) | 367 x 230 |
| MTBF (hrs) | 20,000 |
| Signal input | VGA, DVI-D, HDMI |
| Casing Color | Black (RAL 9005) |
| Weight (Single console | |
| Net | 10.9 kgs (24 lbs) |
| Gross | 15.8 kgs (34.8 lbs) |
| Environmental | |
| Operating | 0 to 50°C Degree |
| Storage | -5 to 60°C Degree |
| Relative humidity | 5~90%, non-condensing |
| Shock | 10G acceleration (11 ms duration) |
| Vibration | 5~500Hz 1G RMS random vibration |
| Regulatory | FCC, CE |
| Power | |
| Input | Auto-sensing 100 to 240VAC, 50 / 60Hz |
| Consumption | Max. 48 Watt, Standby 5 Watt |
| Product Dimensions (Single console) | |
| Product | 441.6 x 480 x 44 mm / 17.4 x 18.9 x 1.73 inch |
| Packing | 590 x 823 x 140 mm / 23.2 x 32.4 x 5.5 inch |



SUN Keyboard / Mouse Options

Se

SUN keyboard integrated with touchpad

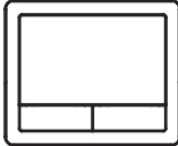

Sb

SUN keyboard integrated with trackball



SUN keyboard integrated with touchpad/trackball

- Incorporates SUN keys, including Stop, Cut, Paste, Compose, Copy and Help
- 104 key notepad keyboard with full numerical pad and SUN function
- USB interface
- US layout only

How to Use "SUN" Keyboard



Num LED in Off mode

Key pad behaves as a SUN Solar system administration command mode



Num LED in Green mode

Key pad behaves as a normal key pad mode

Audio / Display Keys

* Please ask your supplier for full details



F9
Audio : Mute
Display : Degauss



F11
Audio : Decrease volume
Display : Decrease contrast



F12
Audio : Increase volume
Display : Increase contrast

STRUCTURE DIAGRAM

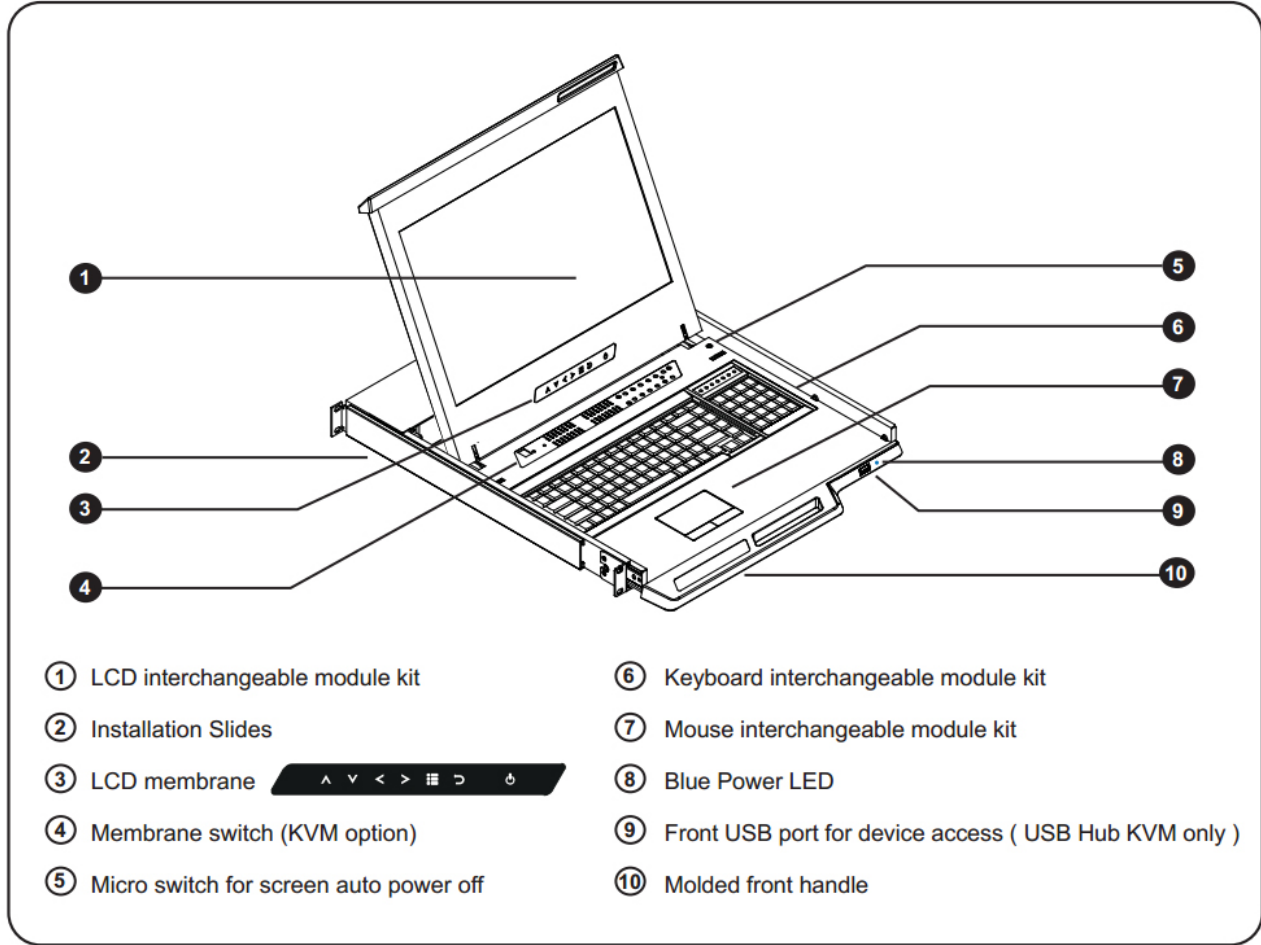

KVM PORT CONNECTION

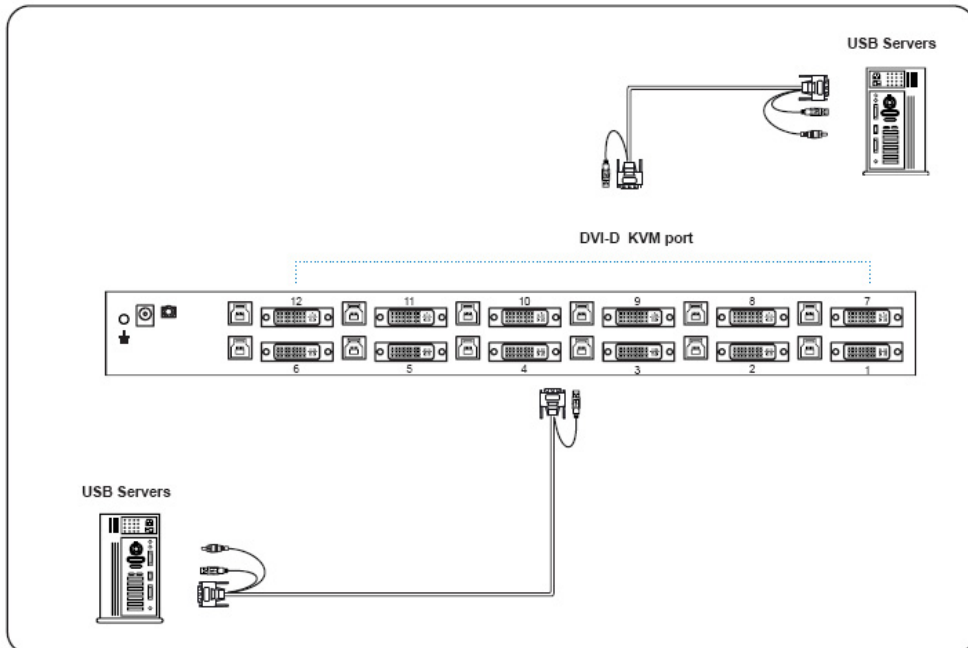

DVI KVM Cable

NC-6: 6 feet DVI KVM Cable

NC-15: 6 feet DVI KVM Cable

(Server end : DVI-D+USB+Audio)

(KVM Port : DVI-D+USB 3.0)



DVI KVM SPECIFICATIONS

| | |
|----------------------|---|
| KVM Port | |
| Number of ports: | 12 |
| Connector: | DVI-D connector |
| | USB 3.0 connector (combined for keyboard, mouse & audio) |
| Connectivity: | Combo 4-in-1 KVM cable, 6 or 15 feet |
| Local Console | |
| Graphic connector: | 1 x DVI-D |
| Resolution: | Up to 1920x1200 |
| Input device: | 2 x USB type A for keyboard & mouse |
| Audio out: | 1 x 3.5mm stereo audio |
| Management | |
| PC Selection: | Front button & keyboard hotkey |
| Compatibility | |
| Multi-platform: | Mix PCs, SUN and Mac G3 / G4 Mac / iMac |
| Support: | Windows 7 / Vista / 2003 / XP, Linux, Unix |

| | |
|----------------------|--|
| Regulatory | |
| Safety: | FCC & CE certified |
| Environment: | RoHS2 & REACH compliant |
| Environmental | |
| Operating: | 0 to 50°C |
| Storage: | -5 to 60°C |
| Relative humidity: | 90%, non-condensing |
| Shock: | 50G peak acceleration (11ms, half-sine wave) |
| Vibration: | 58-100Hz/0.98G (11ms/ cycle) |

Front Panel - Port LED Indications

DVI-D KVM 12 ports

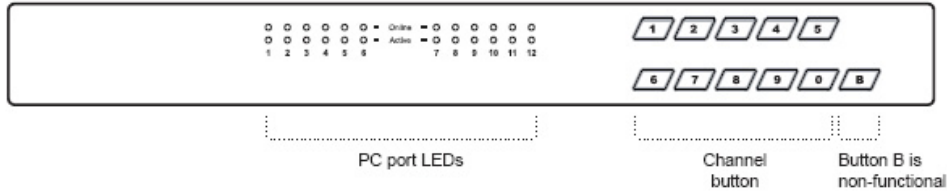

| | |
|----------------|---|
| PC port LEDs | Online : Blue LED on indicating a PC is connecting to the port Active : Green LED on indicating a selected channel |
| Channel button | Press to select channel from 01 to 12 |