



“ATEN had the exact products we needed at a highly affordable price.”

## KVM on the NET™



ATEN's new CN5000, KVM on the NET, is an IP-implemented KVM solution that allows network administrators to access computers from any station connected to the network, whether from the LAN, WAN, or the Internet. Network administrators can enjoy freedom from being bound to the server room; work from anywhere in the office, remote locations, or even from home!

Since KVM on the NET uses TCP/IP as its communication protocol, network administrators can remotely access attached KVM switches, allowing remote control of the attached servers to perform many tasks with ease and speed, such as installing and running GUI applications, BIOS level troubleshooting, routine monitoring, system maintenance, system administration, and rebooting. It supports 10Base-T, 100Base-T, TCP/IP, and HTTP through the Java Client. The server can be accessed whether it is down the hall, on the other side of town, or thousands of miles away! Utilizing advanced security technologies, CN5000 provides password protection, advanced encryption technologies, sophisticated user filters and user management, stealth mode and automatic lockout to make sure that remote access is secure.

Combining with ATEN's power unit (PN0108), users can power on and off the connected computers through Internet. The CN5000 integrates the RADIUS remote authentication protocol. As the need for RADIUS servers increases, the ability to work with RADIUS servers becomes more important. CN5000 offers that ability. With ATEN's patented video compression technology, the CN5000 provides true high resolution (up to 1600 x 1200 @ 60Hz) video quality. User-friendly Windows GUI Client Software and Java client software, simplify the process to operate this KVM unit.

### Features:

- Supports up to 64 user accounts
- Up to 16 users can log in at the same time for concurrent access to a server
- Remote access of KVM switches or servers via LAN, WAN or the Internet
- Protocols: TCP/IP, HTTP, HTTPS, UDP, RADIUS, DHCP, SSL, ARP, DNS
- Advanced security features: 1024 bit RSA encryption, 256 AES, 56 DES
- Three level password protection
- Windows GUI and Java-based client software
- Superior video quality-up to 1600x1200
- Firmware Upgradeable via RJ-45 Ethernet connection
- Remote boot up (with ATEN's power unit, PN0108)
- OS Compatibility: DOS, WIN 98, WIN ME, WIN 2K, WIN 2003, WIN XP and LINUX

# KVM on the NET™

## Configuration:

How does it work? Configuring KVM on the NET™ is easy and quick. All you need is to connect the KVM port to the console ports of the KVM switch, or a particular server. The local console ports allow the out-of-band control over the KVM or the server. The administrator tool and client software are loaded onto the remote PC / laptop that will access the KVM (see illustration). The Java client offers compatibility with any OS on that remote PC, whether it is based upon Linux, Mac or SUN.

Note: For KVM access, CN5000 works seamlessly with all ATEN KVM switches and with most of other brand name KVM switches.

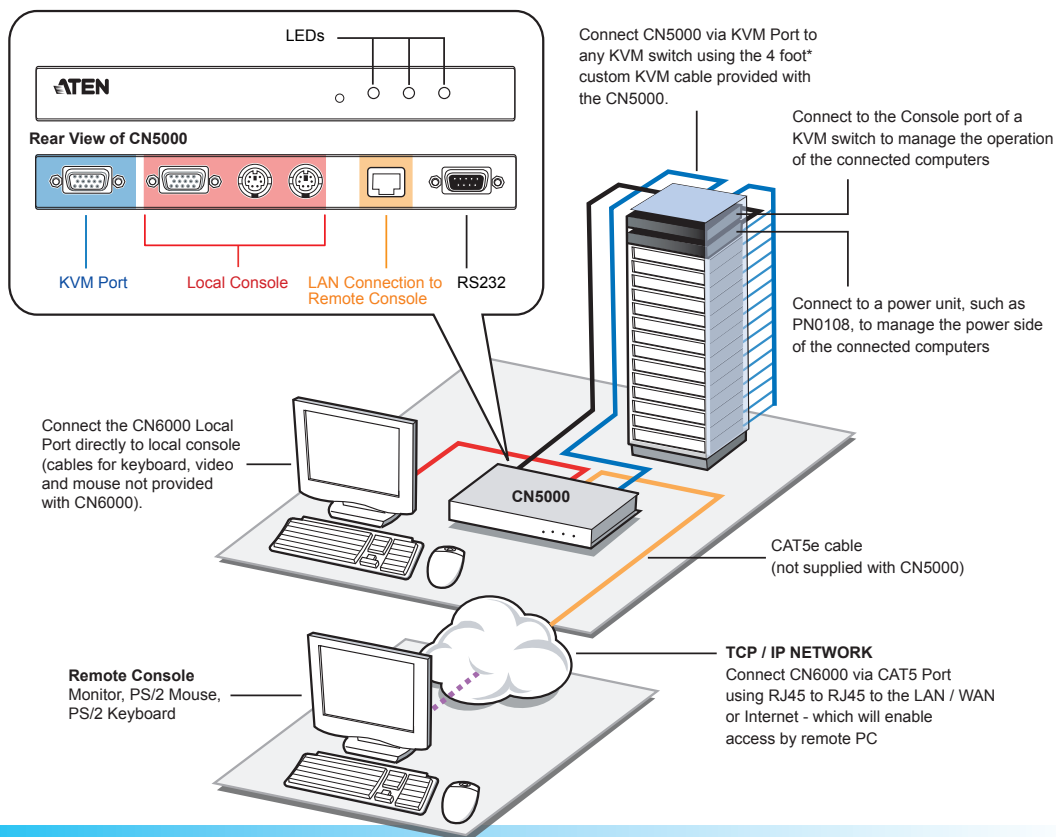

## Requirements:

- For the best output quality, we recommend that the computer used to access CN5000 control unit at least have a PIII 1 GHz processor with 1024 x 768 screen resolution set up
- Browsers must support 128 bit data encryption
- For the best results, we recommend that the internet connection speed be at least 128 Kbps
- For the browser-based Window Client, DirectX 7.0 or higher must be installed
- For the browser-based Java Client, Sun's Java 2 (1.4 or higher) must be installed
- For the browser-based Log Server, Microsoft Jet OLEDB 4.0 or higher driver must be installed.

## Cables:

-For PS/2 computers, use ATEN part number 2L520XP\*  
\*\*X stands for the length of the cable: "1" is 3 ft., "2" is 6 ft., "3" is 10 ft., "5" is 16 ft.

## Accessories:

-Power Over the Net™ (model PN0108)

## Package Contents:

- 1 CN5000 KVM On the Net™
- 1 PS/2 KVM Cable
- 1 Power adapter
- 1 Rack mount kit
- 1 User Manual
- 1 Software CD
- 1 Quick Start Guide / Registration Card

## Specifications:

Local Console Connectors	Keyboard	1 x mini-DIN-6 Female (PS/2)
	Monitor	1 x DB-15 (VGA)
	Mouse	1 x mini-DIN-6 Female (PS/2)
CPU / KVM Connectors	Keyboard, Mouse, and Video	1 x DB-15 Female
Dimensions (H x L x W)		1" x 3.2" x 8" (20 x 8.0 x 2.5 cm)
Encryption		SSL2.0, SSL3.0 and TLS1.0 protocol
Housing		Metal
Humidity		0 - 80% RH
LAN Connection		1xRJ-45 Female
LEDs	10/100 Mbps	1 x Orange / Green
	Link	1 x Green
	Power-on	1 x Orange
Protocols		10Base-T Ethernet; 100Base-T Fast Ethernet; TCP/IP; HTTP2.6A
Reset Switch		1xMomentary Switch
Video Resolution		Up to 1600x1200 @ 60Hz
Weight		1.1 lb (508 g)