

# DRP2D19R2L-DC-V2

## Rugged Dual Screen

## 2U Rack Mount Wide 19" LCD with Touch

The DRP2D19 Series is a high performance 2RU Dual LCD display drawer sporting 2 -19" LCD Monitors. These monitors have high contrast ratios (1000:1) and wide viewing angles with a native SXGA (1280x1024) resolution. They fold away to fit into a 2RU (3.5") space. Other options include Dual and Triple 17" Wide Monitors (1920x1200).

The DRP2D Series is the ultimate compact mobile Side-by-Side Dual and Triple Monitor rack drawer solution utilizing only 2RU. It employs i-Tech's patent pending three part Rack Motion Stabilization System (RMS). The rack slide tensioning position secures the drawer while in operation, while the Secure Stow Technology ensures the monitors do not move in transit. The Gas Shock Monitor Stabilizer coupled with the Multi Position Torque Hinges allow almost infinite monitor positioning.

Video inputs include aRGB, DVI-D, CVS, S-Video, Component, HDMI & Optional HD-SDI. It employs S-IPS (Super In Plane Switching) to produce the industries widest viewing angle 178°/178° and the fastest response time 8 ms).

The Standard Finish is Black Powder Coated Light Texture, but it can be customized to any color or logo.

### Features

- Mounts in standard 19-inch rack cabinets 26-36" depths
- Utilizes only 2RU (35")
- RSI Design (Rapid Start Installation). Installation takes Less than 5 minutes!
- Utilizes i-tech's Rack Motion Stabilization System (RMS) for use while in motion
- Telescoping front ears and rear arms with mounting hardware options for Standard Rack, Transit Case, Flight Pack or Mobile Installations.
- Rugged all Aluminum construction for light weight applications and designed to satisfy Broadcast, Industrial, Commercial, Military and Medical requirements

### Display:

- Dual 19" Diagonal Active Matrix TFT LCD Displays
- 178 / 178 Viewing Angle
- SXGA 1280 x 1024 @ 60 Hz
- Contrast Ratio 1000:1, 300 NITS

### Video Controller:

- Video which includes aRGB, DVI-D, CVS, S-Video, Component, HDMI & Optional HD-SDI (See V09X, V05X, V04X & V03X Controllers in the Video Controller Ref Guide)
- OSD (On Screen Display) Monitor Controls

### Power:

- +12 VDC Operation
- Low Power Consumption

### Options:

- Dual 19" and Triple 17" Wide Monitors (1920x1200)
- Many different Video I/O Configurations
- HD/SD-SDI: (HD/SD-SDI via V03X/V09X Controller)
- Optional Touch Configurations
- Optional Dual Monitor KVM
- Optional Integrated Audio & speakers
- 19" Monitor Only
- -Optional High Bright LED BLU (1200 Nits)
- -Optional ITO Shielding Layer
- -Optional NVIS (Night Vision Imaging Systems)

### Photos (Model: DRP2D19)



## Technical Specifications:

<b>Monitor Name:</b>	19" Production x2
Monitor Size	19"
Display Type	SXGA, Color, TFT-LCD, 4 CCFL BackLight
Max Resolution/Refresh	1280x1024
Aspect Ratio	4:3
Display Colors	16.8M
Brightness (Nits cd/m2)	300
Contrast Ratio	1000:1
Response Time (Tr/Tf) (ms)	8msGTG(Avg. Typ) 20ms(Typ, on/off)
Pixel Pitch (HxW)(mm)	0.294 x 0.294
Power Management	EPA energy star, VESA compliance
Viewing Angle (Deg)	89/89/89/89 Typ.
MTBF (Hours)	30,000-50,000
Surface Treatment	Hard-coating (3H), Non-Glare treatment,
Temperature Operating (C)	0 to +50
Temperature Storage (C)	-20 to +60
Altitude Operating (Ft)	10,000
Altitude Storage (Ft)	30, 000
Humidity Operating (%RH)	5 to 90
Humidity Storage (%RH)	5 to 90
Applicable i-Tech Controllers:	V053, V044, V044a,V034, V035, V036, V094, V095, V096, V097
Video Connections:	VGA, DVI-D, CVS, S-Video, Composite BNC Input
<b>Chassis/ Drawer:</b>	
Mounting	Standard 19-inch rack
Slide Rails	Pre-integrated ball-bearing Slides with cable management guides.
Dimensions (WxHxD)	19 x 1.75 x 26-inch min. Can be installed in 22" - 30" Racks
Monitor Hinge	Heavy-duty Torque hinges to 60 lbs
Color	Black Powder coated with light texture (Custom colors available)
Weight (lbs)	32



Dimensions Drawings

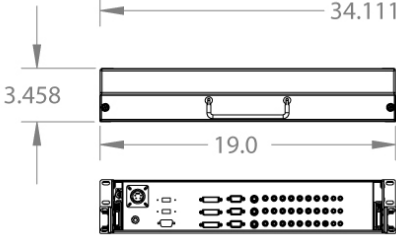
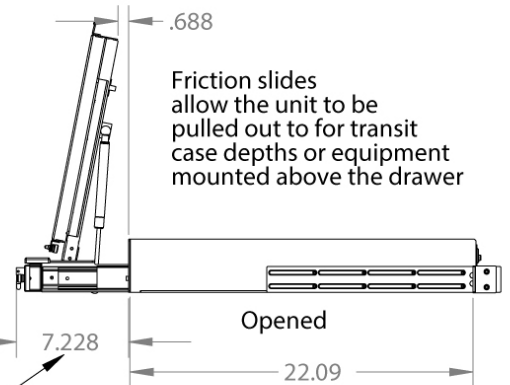
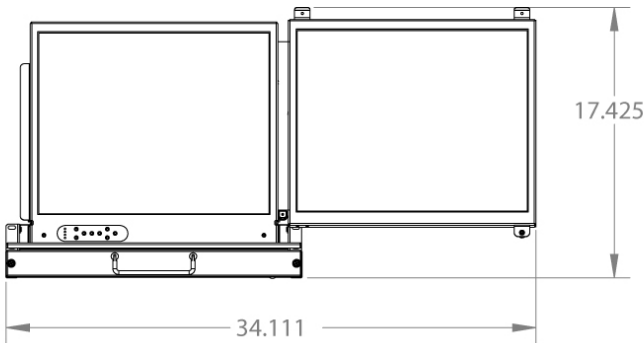
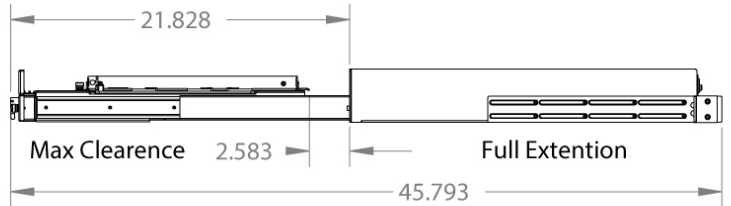
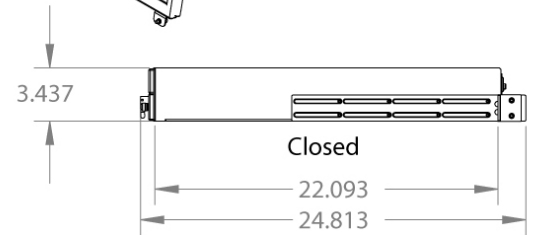
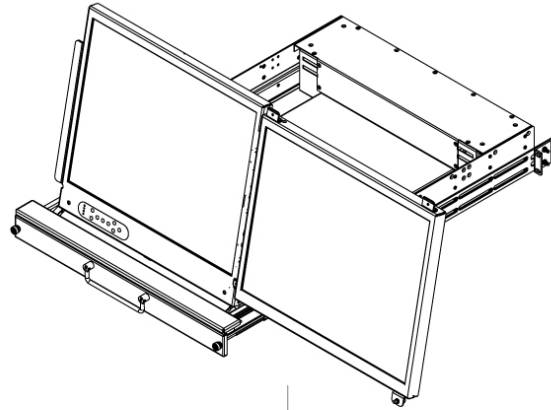
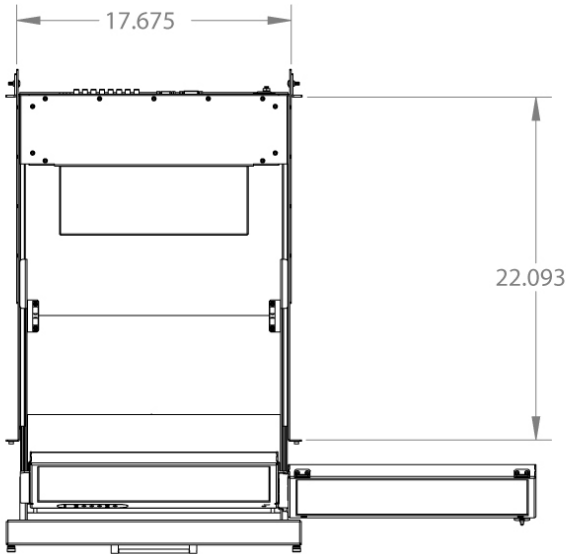

Friction Slides Allow for Infinite Positioning

+8" Telescoping Rear Arms

