

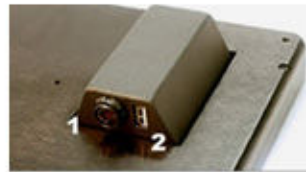

# 12.1" Rugged All-Weather Sunlight Readable LCD

i-Tech's harsh-duty All-Weather Monitor (AWM) is a flat panel display, engineered to survive the most demanding applications. Designed to be rugged, the AWM handles a wide-range of extreme environments making it the industry choice for mobile applications. Housed in a milled billet aluminum case, the slim-profile AWM is light weight and watertight, with fully sealed connectors. Front-mounted controls and the optional touch screen make the monitor user-friendly. The AWM incorporates the latest optical engineering to achieve optimum view ability in all lighting conditions, including direct sunlight. The AWM's power efficient, low heat design results in the increased reliability and longevity required for mission critical deployment.



1 VGA Input  
2 USB Pass-through\*  
\*NOTE: IP67 USB Sealed Plug requires an additional cable  
Standard A-Type USB Socket available (cancels IP67 on enclosure)

## Standard Features

- Digital LVDS Video Input
- 12.1" TFT AM LCD SVGA (800 x 600)
- Brightness Range 5-800 nits
- Transflective Enhancement
- Antireflective/Antiglare Surface Treatments
- Milled AL Case, sealed to IP67 (NEMA 6P) Standard
- Black Anodized Finish
- Single High Flex Cable for all connections
- IP67 Anti-Corrosion Metal Sealed Connectors
- Wide Range Input (8-30 VDC)
- Protected against an Internal Short Circuit, Load Dump, Over Voltage and Reverse Polarity
- 12 Watts Maximum Power Consumption

## Environmental

Operating temperature	0°C to 60°C (32°F to 140°F)
Operating temp. w/ Heater Option	-40°C to 60°C (-40°F to 140°F)
Storage temperature	-40°C to 75°C (-40°F to 167°F)
Shock	50 G
Vibration	5.8 G (5-500 Hz)
IP rating	IP67 (NEMA 6P Submersible) cancelled with Standard A-Type Socket
Humidity	0-100%
EMI	Designed to Meet FCC B, CE
Altitude	45,000 ft.

## Optional Features

- 12.1" TFT AM LCD XGA (1024 x 768)
- USB Pass-through with Standard A-Type Socket, unsealed (cancels IP67 on enclosure)
- Analog Resistive Touch Screen
- Night Vision Goggle Filter (MIL-STD-3009)
- Flush Mount Bezel, IP67 sealed
- Internal Heaters for operating to -40°C (-40°F)

## Technical

Display	12.1" TFT AM, SVGA, LCD, 256K Colors (XGA Display Optional)
Sunlight Readable	800 nits, Transflective, AR /AG
Dimming Ratio	100:1
Video Input	LVDS
Connectors	IP67 Fischer High Density
Housing	Milled Aluminum, Black Anodized, UV Clear Coat
Mounting	Panel Mount or RAM Mount
Power Consumption	4 Watts Min - 12 Watts Max
Wide Range DC	8-30 VDC (12, 24, 28 VDC nominal)
Power Input	
Power Conditioning	Internal Short Circuit Protection Load Dump Protection Over Voltage Protection Reverse Polarity Protection

## Dimensions

	Millimeters	Inches
Height	234 mm	9.20"
Width	331 mm	13.00"
Depth (Main Case)	30 mm	1.17"
Connector Pod Depth	29 mm	1.11"
Weight	2.7 kg/6.0 lbs	



**Toll Free: 1-888-itech-18 USA Phone: 1-510-429-9288 Fax: 1-510-372-2736**  
**E-mail: sales@i-techcompany.com 30081 Ahern Ave Union City, CA 94587 USA**

www.i-techcompany.com www.i-techcompany.com www.i-techcompany.com www.i-techcompany.com



**Model: DOD1200L**

# 12.1" Rugged All-Weather Sunlight Readable LCD

## Mechanical Drawings

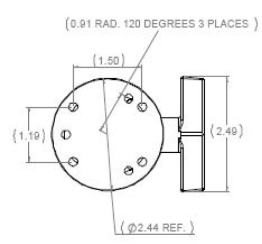
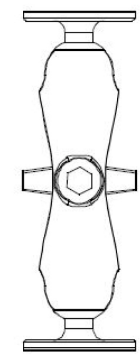
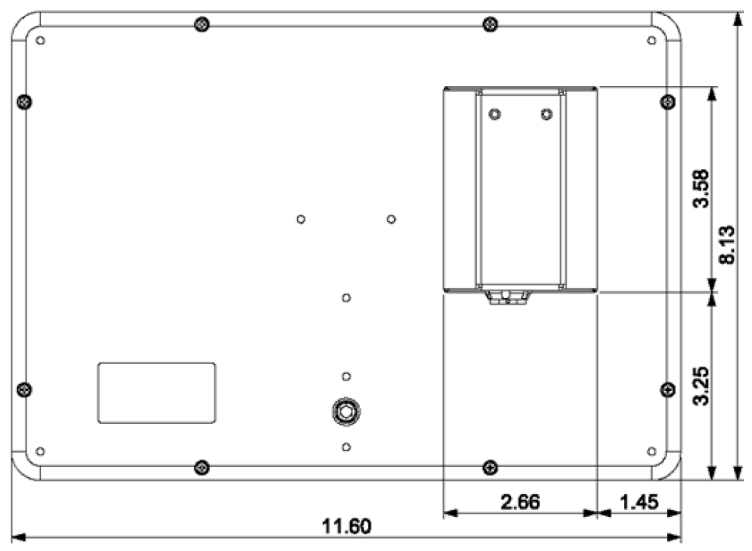
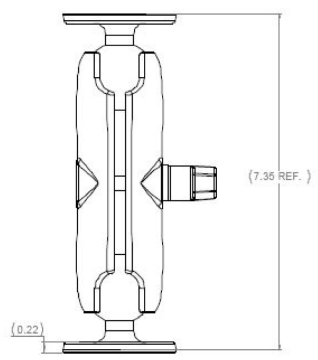
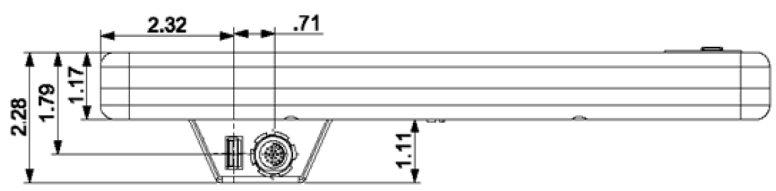
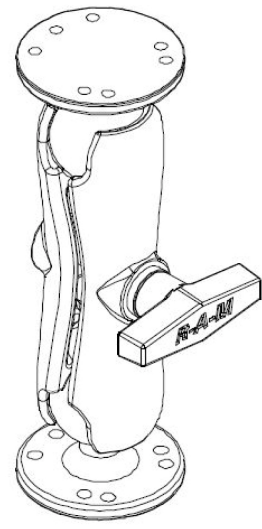
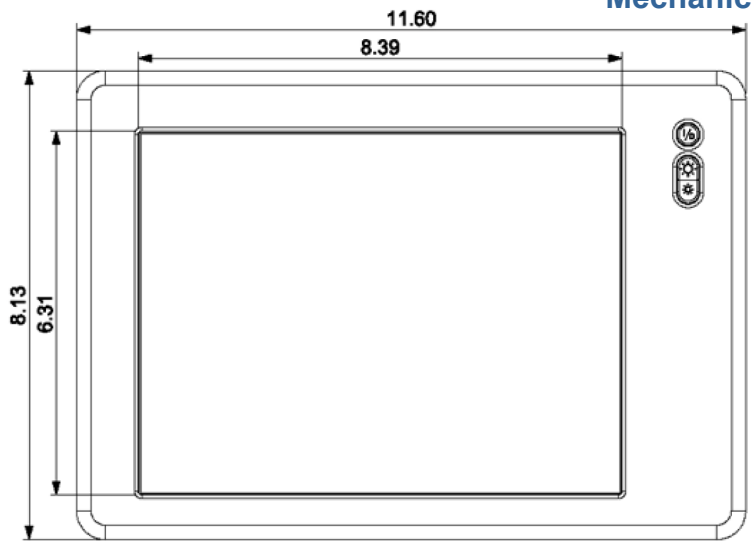

**Toll Free: 1-888-itech-18 USA Phone: 1-510-429-9288 Fax: 1-510-372-2736**  
**E-mail: sales@i-techcompany.com 30081 Ahern Ave Union City, CA94587 USA**

www.i-techcompany.com www.i-techcompany.com www.i-techcompany.com www.i-techcompany.com