

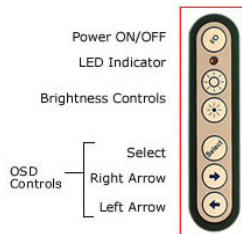

**Model: DOD1200R**

# 12.1" Rugged All-Weather Sunlight Readable LCD

i-Tech's harsh-duty All-Weather Monitor (AWM) is a flat panel display, engineered to survive the most demanding applications. Designed to be rugged, the AWM handles a wide-range of extreme environments making it the industry choice for mobile applications. Housed in a milled billet aluminum case, the slim-profile AWM is light weight and watertight, with fully sealed connectors. Front-mounted controls and the optional touch screen make the monitor user-friendly. The AWM incorporates the latest optical engineering to achieve optimum viewability in all lighting conditions, including direct sunlight. The AWM's power efficient, low heat design results in the increased reliability and longevity required for mission critical deployment.



## Standard Features

- Analog RGB Video Input
- Auto Scaling VGA to UXGA
- 12.1" TFT AM LCD SVGA (800 x 600)
- Brightness Range 5-800 nits
- Transflective Enhancement
- Antireflective/Antiglare Surface Treatments
- 3 Button OSD User Interface
- Milled AL Case, sealed to IP67 NEMA 6P Standard
- Black Anodized Finish
- IP67 Anti-Corrosion Metal Sealed Connectors
- Industry Standard PC Connection
- Wide Range Input (8-30 VDC)
- Protected against an Internal Short Circuit, Load Dump, Over Voltage and Reverse Polarity
- 20 Watts Maximum Power Consumption

## Optional Features

- USB Pass-through with IP67 Sealed Connector
- Analog Resistive Touch Screen
- Night Vision Goggle Filter (MIL-STD-3009)
- Flush Mount Bezel, IP67 Sealed
- Internal Heaters for operating to -40°C (-40°F)
- External VAC Power Supply

## Specification

### Technical

Display	12.1" TFT AM, SVGA, LCD, 256K Colors
Sunlight Readable	800 nits, Transflective, AR /AG
Dimming Ratio	100:1
Video Input	RGB
Connectors	IP67 Fischer High Density to DB-15 JAE to Flying leads DC Input JAE to DB-9 Touch (optional) JAE to USB Port (optional)
Housing	Milled Aluminum, Black Anodized, UV Clear Coat
Mounting	Panel Mount or RAM Mount
Power Consumption	6 Watts Min - 20 Watts Max
Wide Range DC Power Input	8-30 VDC (12, 24, 28 VDC nominal)
Power Conditioning	Internal Short Circuit Protection Load Dump Protection Over Voltage Protection Reverse Polarity Protection

### Environmental

Operating temperature	0°C to 60°C (32°F to 140°F)
Operating temp. w/ Heater Option	-40°C to 60°C (-40°F to 140°F)
Storage temperature	-40°C to 75°C (-40°F to 167°F)
Shock	50 G
Vibration	5.8 G (5-500 Hz)
IP rating	IP67 (NEMA 6P Submersible)
Humidity	0-100%
EMI	Designed to Meet FCC B, CE
Altitude	45,000 ft.

### Dimensions

	MILLIMETERS	SINCHES
Height	234 mm	9.20"
Width	331 mm	13.00"
Depth (Main Case)	27 mm	1.05"
Connector Pod Depth	29 mm	1.12"
Weight	2.7 kg/ 6 lbs	

### Cables

Included	Power, VGA Touch*, USB*
----------	----------------------------



**Toll Free: 1-888-itech-18 USA Phone: 1-510-429-9288 Fax: 1-510-372-2736**

**E-mail: sales@i-techcompany.com 30081 Ahern Ave Union City, CA 94587 USA**

www.i-techcompany.com www.i-techcompany.com www.i-techcompany.com www.i-techcompany.com



Model: DOD1200R

# 12.1" Rugged All-Weather Sunlight Readable LCD

## Mechanical drawing

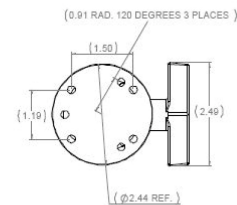
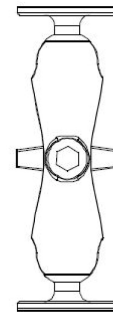
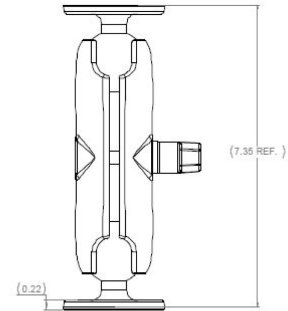
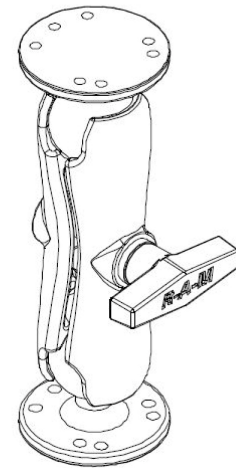
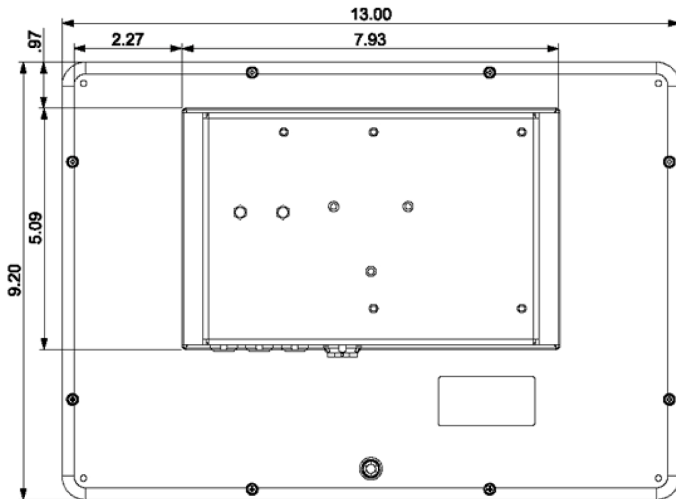
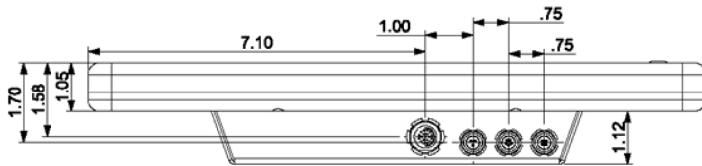
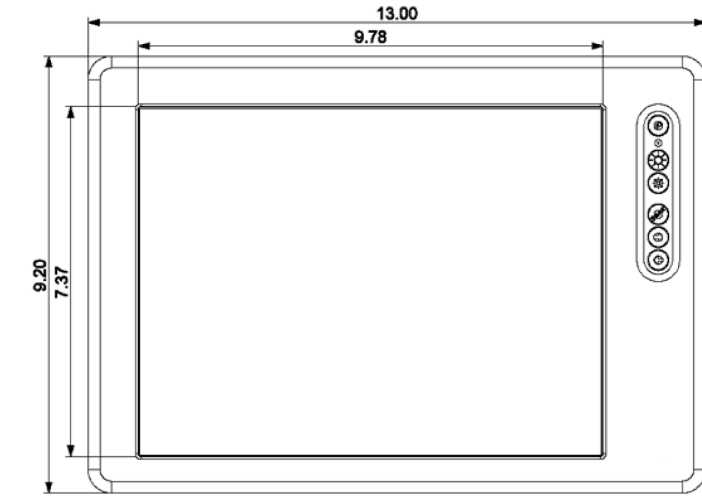





**Model: DOD1200R**

# 12.1" Rugged All-Weather Sunlight Readable LCD

## Flush Mount Mechanical Drawing

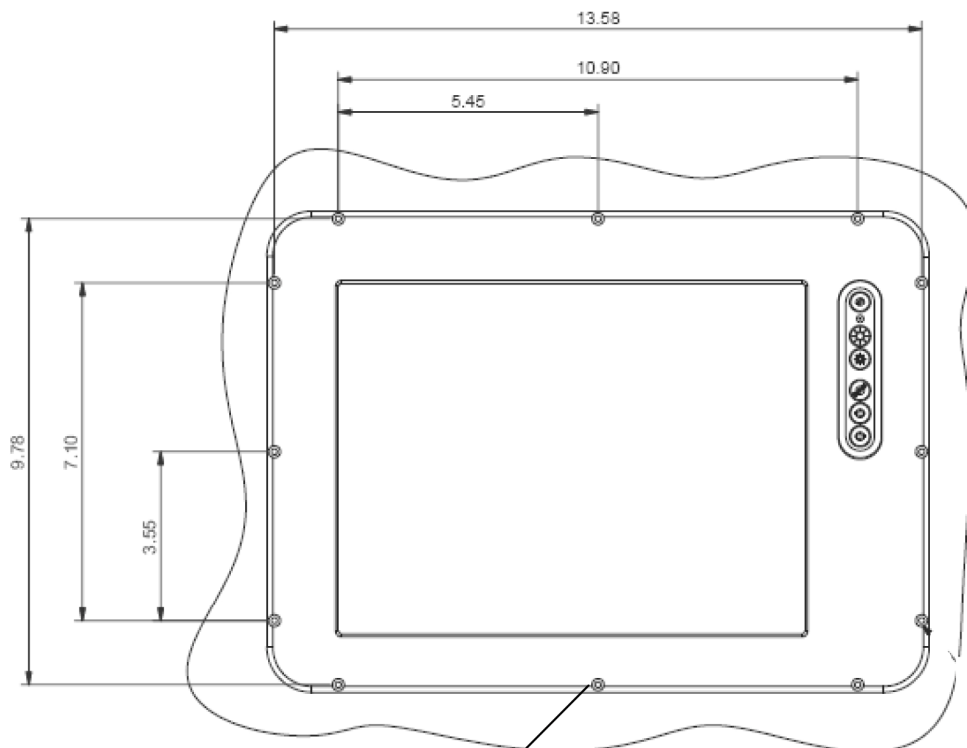

Stainless Mounting Screws, Nuts and sealing washers provided

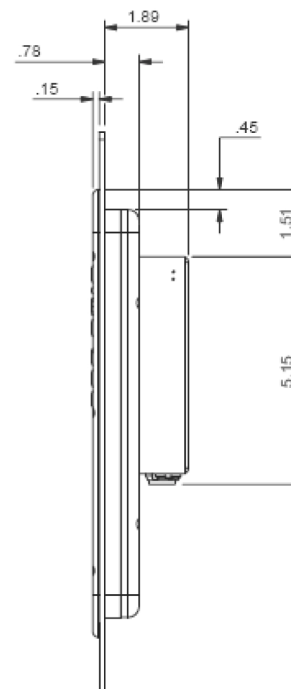
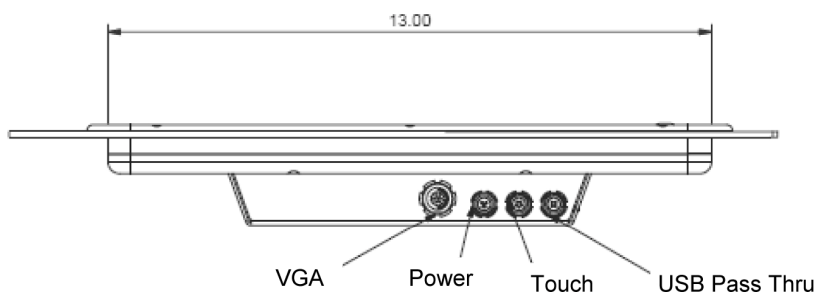



**Model: DOD1200R**

# 12.1" Rugged All-Weather Sunlight Readable LCD

