

**Front View**

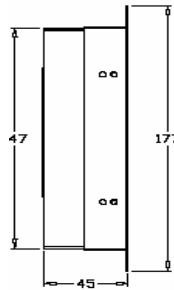

**Side View**

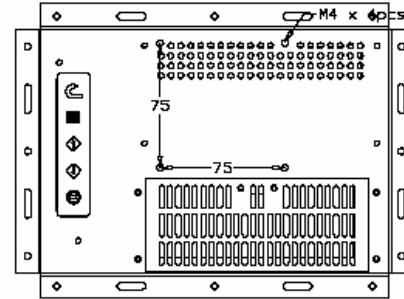

**Rear View**

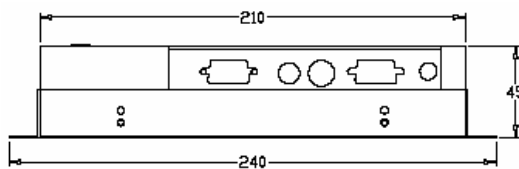

**Bottom View**

### LCD Screen

LCD Type	Grade A industrial TFT LCD Panel	
Display Size	6.4 inch diagonal (129.6H x 97.44V)	
Resolution	640 x 480, VGA	
Display Color	262,144 color	
Brightness	300 cd/m <sup>2</sup>	
Contrast Ratio	180 : 1 (Typical)	
Pixel Pitch	0.203 x 0.203 mm	
Viewing Angle	55 / 55 / 15 / 35 (L / R / U / D)	
OSD Control	Brightness, Contrast, Phase & Clock, Color, H & V position, Auto-tune & Recall	
VGA Connector	D-Sub 15 pin VGA analog	
Video Input	S-Video and RCA Composite	
LCD LLT.	20,000 hrs	
Mounting	Flexible front mount	
Dimension	240(W) x 177(H) x 45(D) mm	
Weight	1 kg (Net) / 3 kg (Gross)	
Packing	480(L) x 362(W) x 85(H) mm	

### Touch Screen

Type	Resistive	Surface Wave
Thickness	2mm	3mm
Light transmission	82%	90%
Controller Interface	Serial / USB	Serial / USB
Durability	35 Million	50 Million
OS Support	Windows XP, 2000, NT, 98, DOS and	

### External Power Adapter

AC Input	110V ~ 220V AC Input
DC Input	12V@3A Output
AC Cable Length	180cm
DC Cable Length	182cm
Adapter size mm	108(L) x 64(W) x 30(H)

### Environmental

Operating Temperature	-20 to 70°C
Storage Temperature	-30 to 70°C
Humidity	95%, non condensing
Shock	49G peak acceleration ( 11ms, half sine wave)
Vibration	58~500Hz/0.98G (11min/cycle)

### Ordering Information

Model	Description
iOP-600	6.4" Open Frame LCD Panel
iOP600-TRS	6.4" OF Panel w/ Res. touch screen (Serial)
iOP600-TRB	6.4" OF Panel w/ Res. touch screen (USB)
iOP600-TWS	6.4" OF Panel w/ Wave touch screen (Serial)
iOP600-TWB	6.4" OF Panel w/ Wave touch screen (USB)
iOP-600AV	6.4" Open Frame LCD Panel w/ Video Input
iOP600AV-TRS	6.4" OF Panel w/ Video, Res. touch screen (Serial)
iOP600AV-TRB	6.4" OF Panel w/ Video, Res. touch screen (USB)
iOP600AV-TWS	6.4" OF Panel w/ Video, Wave touch screen (Serial)
iOP600AV-TWB	6.4" OF Panel w/ Video, Wave touch screen (USB)