

# KPC Series

## STANDARD TOUCH PANEL PC

Suitable for applications such as automation, monitoring, control & data processing in various fields

### Model: KPC1900i5

Fanless 19" industrial panel PC with 5 wires resistive touch screen (Intel i5 4300U industrial mainboard (CPU on board) + standard panel PC with aluminum front bezel(silver) + 12V DC in external power adapter + 3 x RS 232 + 2 x USB + 2 x GLAN + 1 x VGA + 1 x Mini PCle slot + VESA mounting 100 x 100mm + Resolution: 1280 x 1024dpi)

-  Dissipation Design Fanless, (No) external heat sink
-  Waterproof Design IP65 front bezel, Waterproof gasket (optional)
-  Housing Design Aluminum front bezel + metal chassis
-  CPU Performance
-  Energy Efficiency
-  Touch Function

### Features:

- A wide range of CPU solutions from entry to professional level
- IP65 compliant aluminum front bezel
- 5-wire resistive touch screen
- A variety of I/O ports and expansion slots for more applications



PC-based automation systems have been widely used in many industries to help manufacturers realize electronic standard operating procedures to minimize cost / engineering effort and to enhance productivity. Some considerations should be taken into account when deploying an automation system, such as computing performance, power efficiency, budget, scalability, compatibility to the existing system and something alike.

With the following features, iTechLCD's KPC Series is a standard touch panel PC which can satisfy general applications such as automation, monitoring, control & data processing in various fields.

- A wide range of selectable CPU solution from entry to professional level to meet any computing performance requirement and budgetary target
- A wide array of panel size selection from 8.4" to 21.5" with both 3:4 and 16:9 aspect ratios for larger sizes for easy deployment on your systems
- A variety of I/O ports and expansion slots for more possibility of advanced applications
- IP65 compliant aluminum / stainless steel front bezel and the optional waterproof gasket design to provide basic waterproof protection against water spray from the front side

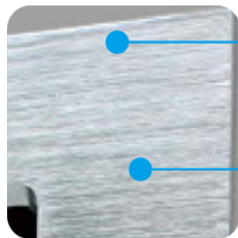

IP65 compliant aluminum / stainless steel front bezel  
*to provide basic waterproof protection against water spray from the front side*

Hairy brushed finish  
*to deliver an aesthetic appearance*



Waterproof gasket design (optional)  
*to strengthen basic waterproof protection against water permeation through the seam between bezel and mount wall / object*

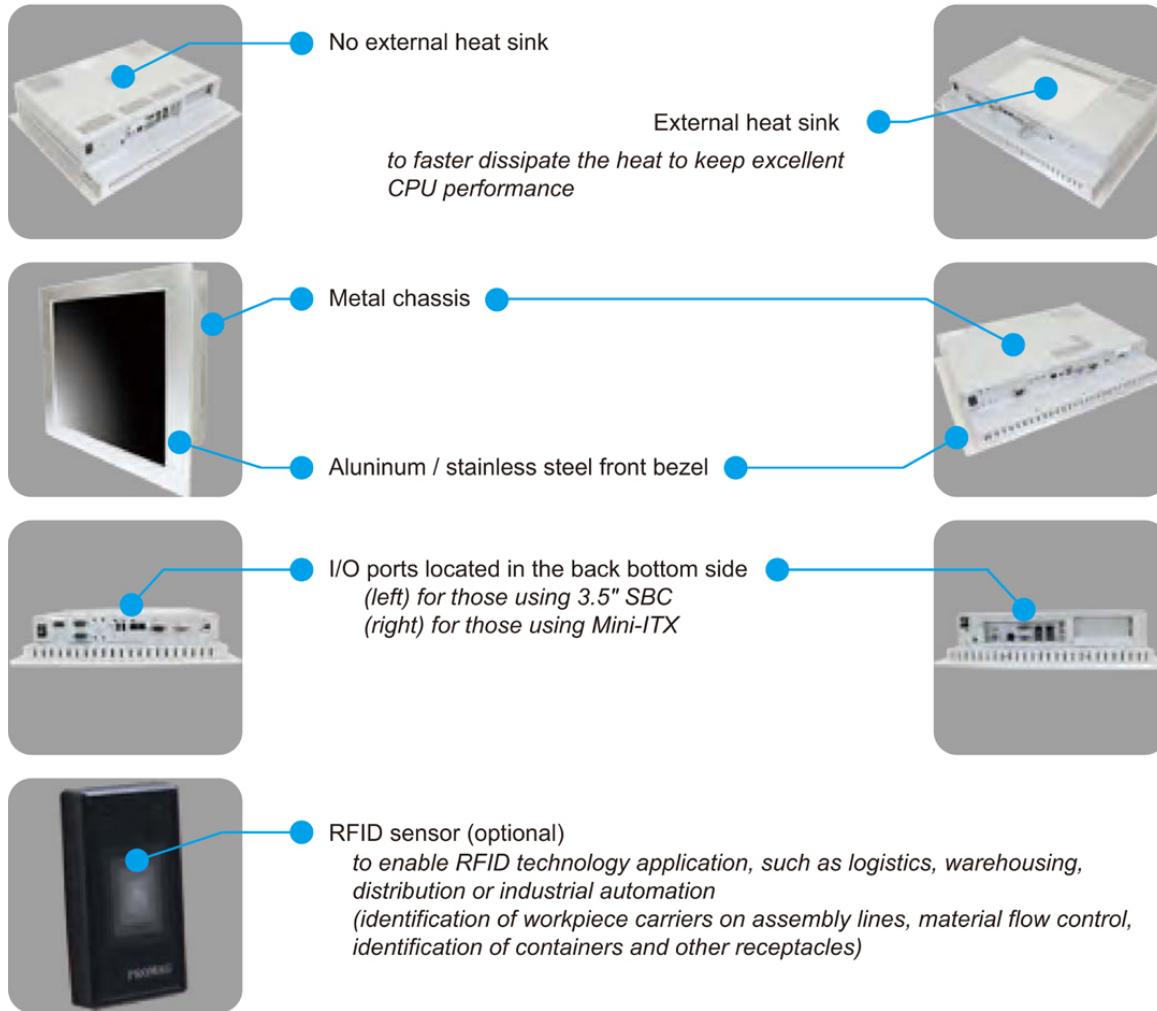

## Specifications:

### PC Specifications

<b>CPU</b>	Intel i5 4300U
<b>Memory</b>	2 x 204-pin SODIMM Dual-channel DDR3L 1333 / 1066MHz up to 8 GB
<b>Power Supply</b>	DC in 12V external power adaptor
<b>I/O Ports (Default)</b>	1 x RS232, 1 x GLAN, 4 x USB, 1 x VGA, 1 x Line-out, 1 x Mic-in, 1 x SATA socket
<b>I/O Ports (Optional)</b>	Extra 2 x RS232, Extra 2 x USB
<b>Expansion</b>	1 x PCIe slot, 1 x Mini PCIe slot (w/ mSATA function)
<b>Operation Temperature</b>	0°C ~ 45°C
<b>Storage Temperature</b>	-10°C ~ 70°C
<b>Relative Humidity</b>	10% ~ 90% non-condensing
<b>OS Support</b>	Win 7 Pro, Embedded 7, Win 8 Pro, Embedded 8
<b>Installation</b>	Clip mount, Panel mount & VESA mount 75 x 75 mm (12.1") / 100 x 100 mm (15" ~ 21.5")
<b>Optional Items</b>	Waterproof gasket, External DVD-RW driver, RFID sensor, None touch screen, Open frame, Stainless front bezel, Mounting clips, Memory, Storage devices, WiFi, OS

### LCD Specifications

<b>Display</b>	<b>Size / Aspect Ratio</b>	19" TFT (4:3)
	<b>Backlight</b>	LED
	<b>Resolution</b>	1280 x 1024
	<b>Colors</b>	16.7M
	<b>Luminance (cd/m2)</b>	250
	<b>Contrast Ratio</b>	1000:1
	<b>Viewing Angle (H/V°)</b>	170/160
	<b>MTBF (hrs)</b>	50,000
	<b>Touch Screen</b>	5-wire resistive
<b>Dimension (W x H x D, mm)</b>	487 x 376.8 x 74.8	
<b>Weight (kg)</b>	11.5	
<b>OSD Controller</b>	No	

## Mechanical Drawing

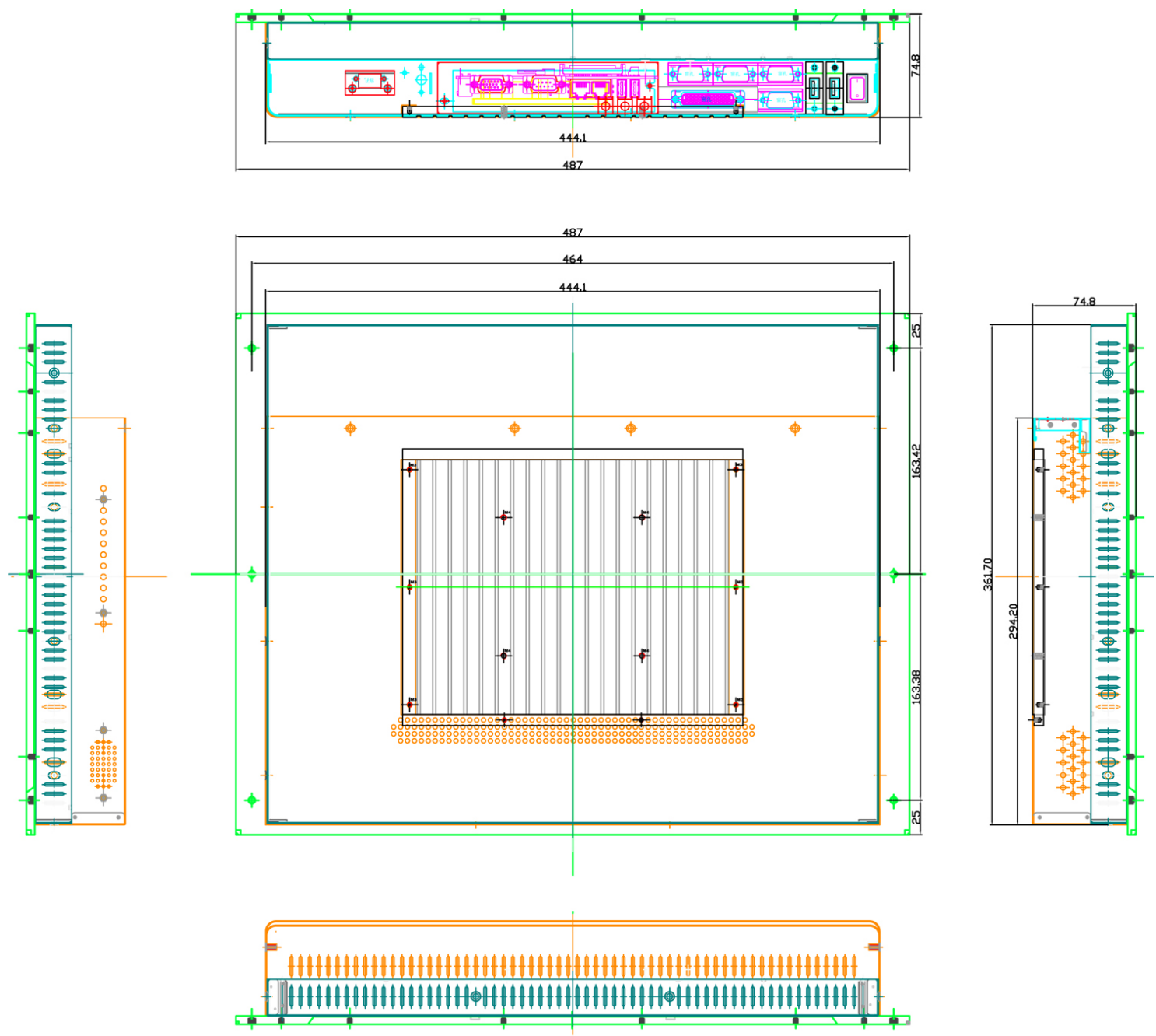

**PANEL CUT - OUT Dimensions : 446.1 x 363.70 m/m**