

KPC Series

STANDARD TOUCH PANEL PC

Suitable for applications such as automation, monitoring, control & data processing in various fields



Model: KPCW1560-i5

Fanless 15.6" industrial panel PC with 5 wire resistive touch screen (Intel i5 4300U industrial mainboard (CPU on board) + standard panel PC with aluminum front bezel (silver) + DC in external power adapter + panel mount & VESA mounting 100 x100mm + resolution: 1366 x 768 dpi)

-  **Dissipation Design** Fanless, (No) external heat sink
-  **Waterproof Design** IP65 front bezel, Waterproof gasket (optional)
-  **Housing Design** Aluminum front bezel + metal chassis
-  **CPU Performance**
-  **Energy Efficiency**
-  **Touch Function**

Features:

- Fanless design and compact solution Fanless solution and compact design
- 4th Intel i5 CPU (CPU on board)
- Resolution 1366 x 768 & 1920 x 1080 dpi
- 5 wires resistive touch solution
- IP65 Silver aluminum front bezel
- 4 x USB, 1 x HDMI, 2 x LAN
- Panel mount & VESA mounting & Clips



PC-based automation systems have been widely used in many industries to help manufacturers realize electronic standard operating procedures to minimize cost / engineering effort and to enhance productivity. Some considerations should be taken into account when deploying an automation system, such as computing performance, power efficiency, budget, scalability, compatibility to the existing system and something alike.

With the following features, iTechLCD's KPC Series is a standard touch panel PC which can satisfy general applications such as automation, monitoring, control & data processing in various fields.

- A wide range of selectable CPU solution from entry to professional level to meet any computing performance requirement and budgetary target
- A wide array of panel size selection from 8.4" to 21.5" with both 3:4 and 16:9 aspect ratios for larger sizes for easy deployment on your systems
- A variety of I/O ports and expansion slots for more possibility of advanced applications
- IP65 compliant aluminum / stainless steel front bezel and the optional waterproof gasket design to provide basic waterproof protection against water spray from the front side

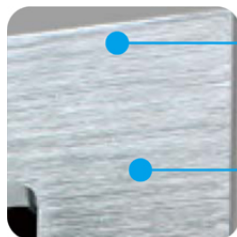

IP65 compliant aluminum / stainless steel front bezel
to provide basic waterproof protection against water spary from the front side

Hairy brushed finish
to deliver an aesthetic appearance



Waterproof gasket design (optional)
to strengthen basic waterproof protection against water permeation through the seam between bezel and mount wall / object



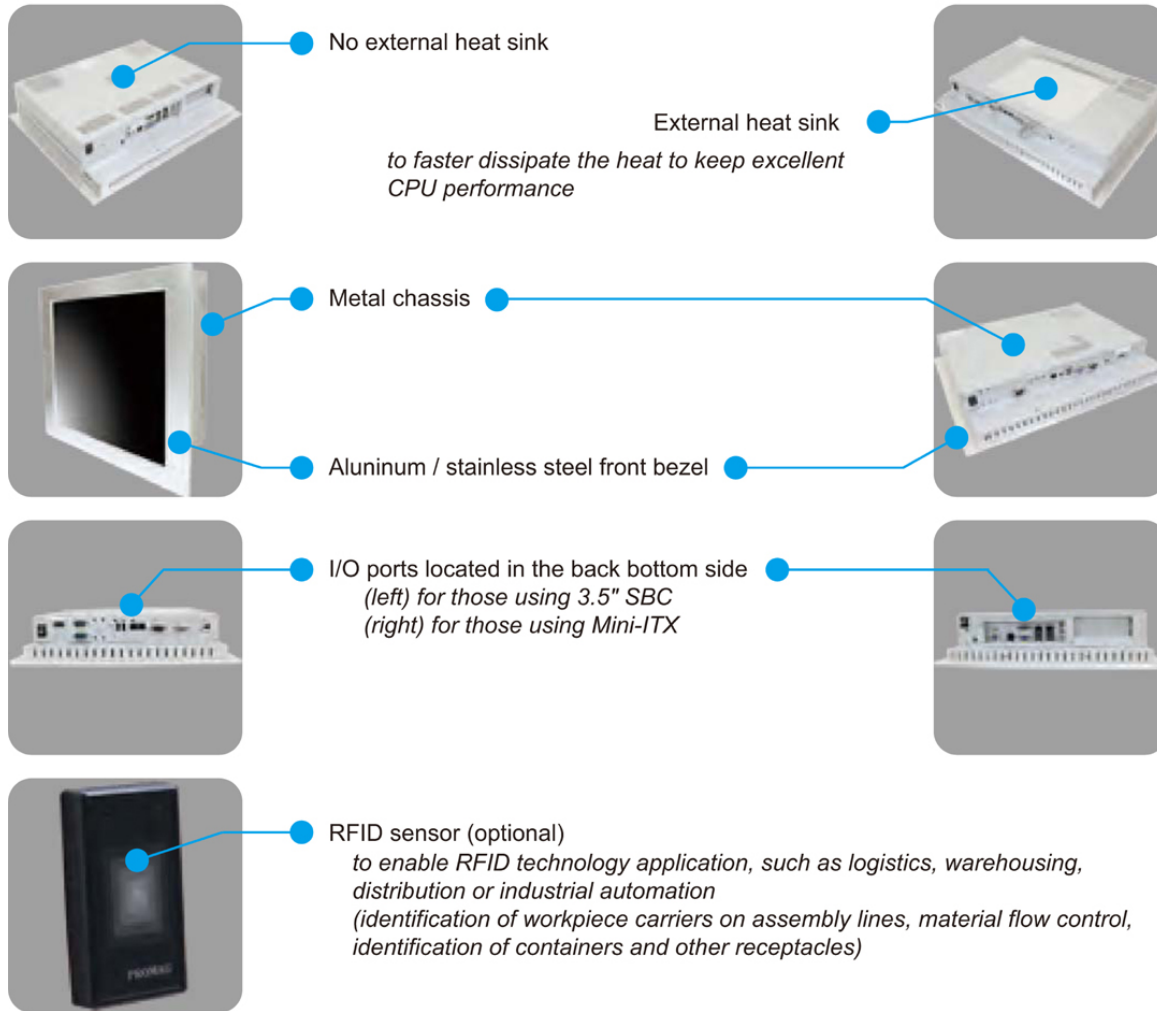

No external heat sink

External heat sink

to faster dissipate the heat to keep excellent CPU performance

Metal chassis

Aluminum / stainless steel front bezel

I/O ports located in the back bottom side (left) for those using 3.5" SBC (right) for those using Mini-ITX

RFID sensor (optional)

to enable RFID technology application, such as logistics, warehousing, distribution or industrial automation (identification of workpiece carriers on assembly lines, material flow control, identification of containers and other receptacles)

Specifications:

SYSTEM	
CPU	Intel 4th Gen Intel® Core™HSW ULT i5 4300U CPU (CPU OnBoard) □
Memory	2 x 204-pin DDR3L SODIMM up to 16 GB
HW MONITOR	
Watchdog Timer	256-Level Watchdog Timer
I/O PORTS	
RS232	1
GLAN	2
USB	4
HDMI	2
Relative Humidity	1
STORAGE	
Storage	1 x SATA 2.0 2.5" HDD/SSD
EXPANSION	
Mini-PCIe	1 x Full-size (one w/ mSATA)
POWER REQUIREMENT	
Power Input Voltage	DC in 12V or 19~24V
TOUCHSCREEN	
Touch screen	5-wire resistive
DISPLAY	
Power	19~24V
Size	15.6" TFT (16:9)
Resolution	1366 x 768
Colors	16.7 M
Luminance (cd/m2)	300
Contrast Ratio	500:1
View Angle (H / V)	170/160

MECHANICAL & ENVIRONMENTAL	
Operation Temp	0 ~ 45°C
Storage Humidity	10 ~ 90%, non-condensing
Mount	Clip mount, Panel mount & VESA mounting(100X100mm)
Dimension (W x H x D mm) Weight	454 x 272.4 x 75 (13kg)
OPTIONAL	
RAID	1
RS232/422/485	2
External antenna	1 or 2
Waterproof Sponge	1

Mechanical Drawing

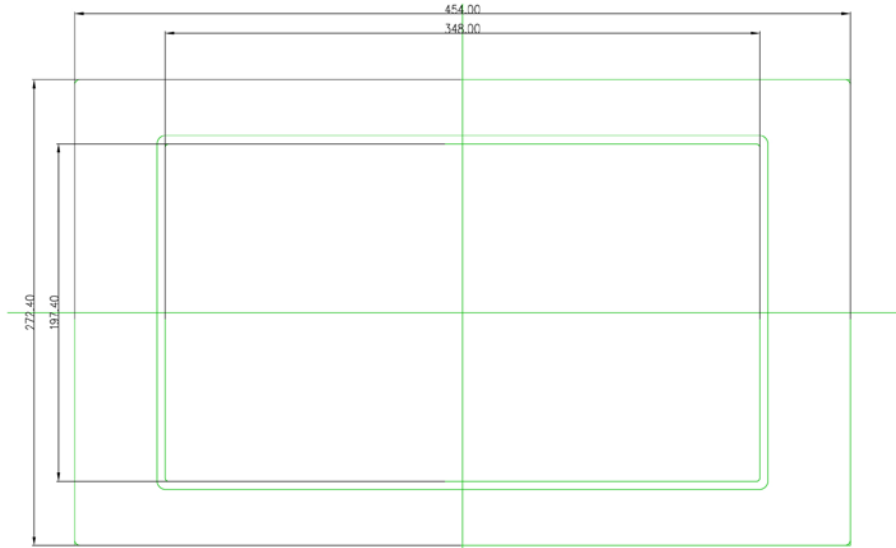

15.6 PANEL CUT .OUT Dimensions : 410* 259 m/m

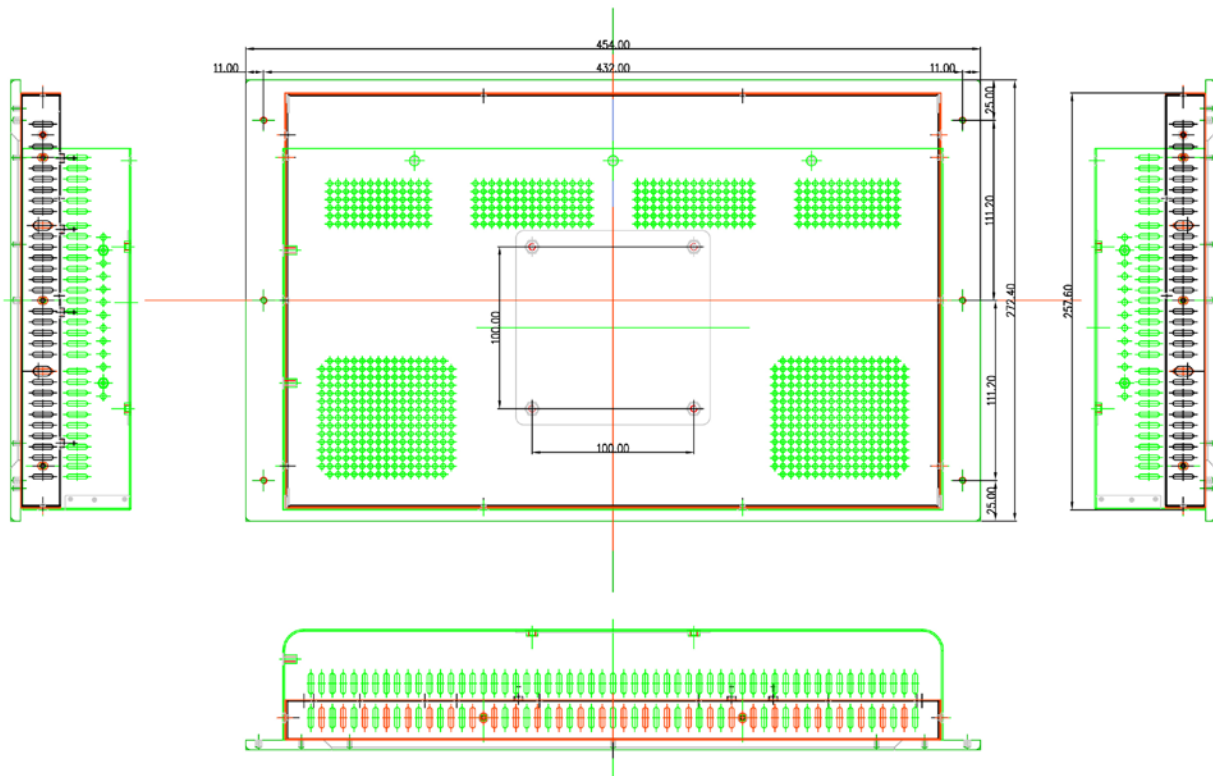
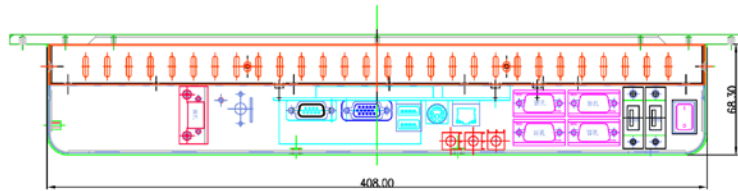

15.6 PANEL CUT .OUT Dimensions : 410* 259 m/m