

ALL IN ONE INDUSTRIAL PC

All In One Industrial Computer 10.4" 800x600, 250nits
with 5 wired Resisitive Touchscreen,
NO Memory
NO Storage
NO OS

MODEL: LPC1040-J-TR

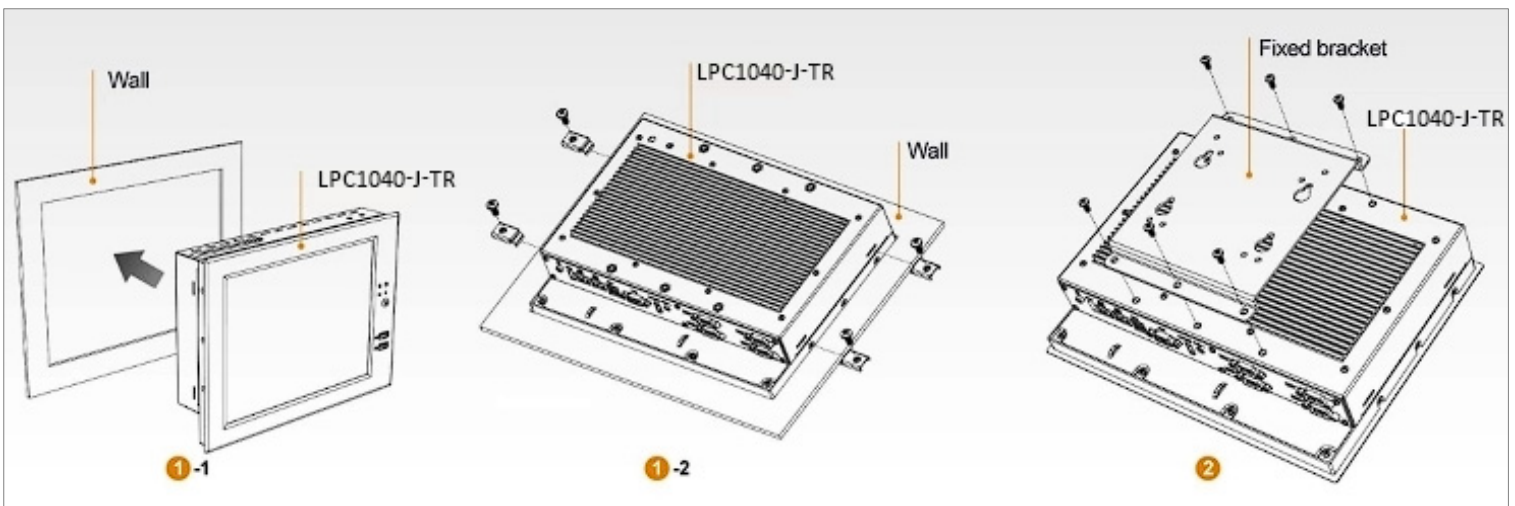

1. Mount from the front of wall, fixed with lock and screw. It's more convenient for customers to control & maintain device behind the wall.
2. Screwed with fixed bracket. It's much more easily to be hung on the wall, also available for 75mm / 100mm VESA standard mount

SPECIFICATIONS

DISPLAY	Display Screen	10,4" LED baaklight
	Resolution	800x600 (1,440,000)pixels
	Touch Panel	5-wire resistive
	Brightness	250cd/m
	Aspect Ratio	4:3
	Contrast Ratio	5001
SYSTEM	Viewing Angle	140/110(H/V)
	OS(optional)	Windows 10/Linux
	CPU	Inter J1900 (quad core 2.0GHz)
	Memory	-
MAINBOARD	Storage	PCie mSATA, Supports up to 1TB 2.5inch SATA HDD (Optional)
	Chipset	Intel Bay TRail Chipset
	L2Cache	1024KB x2
	Sound Card	6 channels
	Expansion	Built-in Mini PCIe x 1, optional for 4G/WiFi
POWER	Interface	HDMI output, VGA output, USB 2.0x3, USB 3.0x2, Earphone Jack, DC power input, 4x (COM 2/3, support RS232/RS485), LAN x2, Antenna slot x2
	Input	12V DC input with external power adapter
	Current	1.3A
ENVIRONMENT	Power Consumption	<16W
	Operation temperature	0~50°C
DIMENSION	Storage Temperature	-10~65°C
	Dimension (LWD)	280*210*58.8mm
	Weight	2190g

**Specifications subject to change without notice, not responsible for typographical errors.*

ACCESSORIES

1. DC adapter
2. Fixed bracket
3. Manual
4. 2.5 inch SATA HDD (optional)

