



i-TECH COMPANY LLC

i-Tech Company LLC

TOLL FREE: (888) 483-2418 • EMAIL: info@itechlcd.com • WEB: www.iTechLCD.com

Terminal Block for 9/36VDC

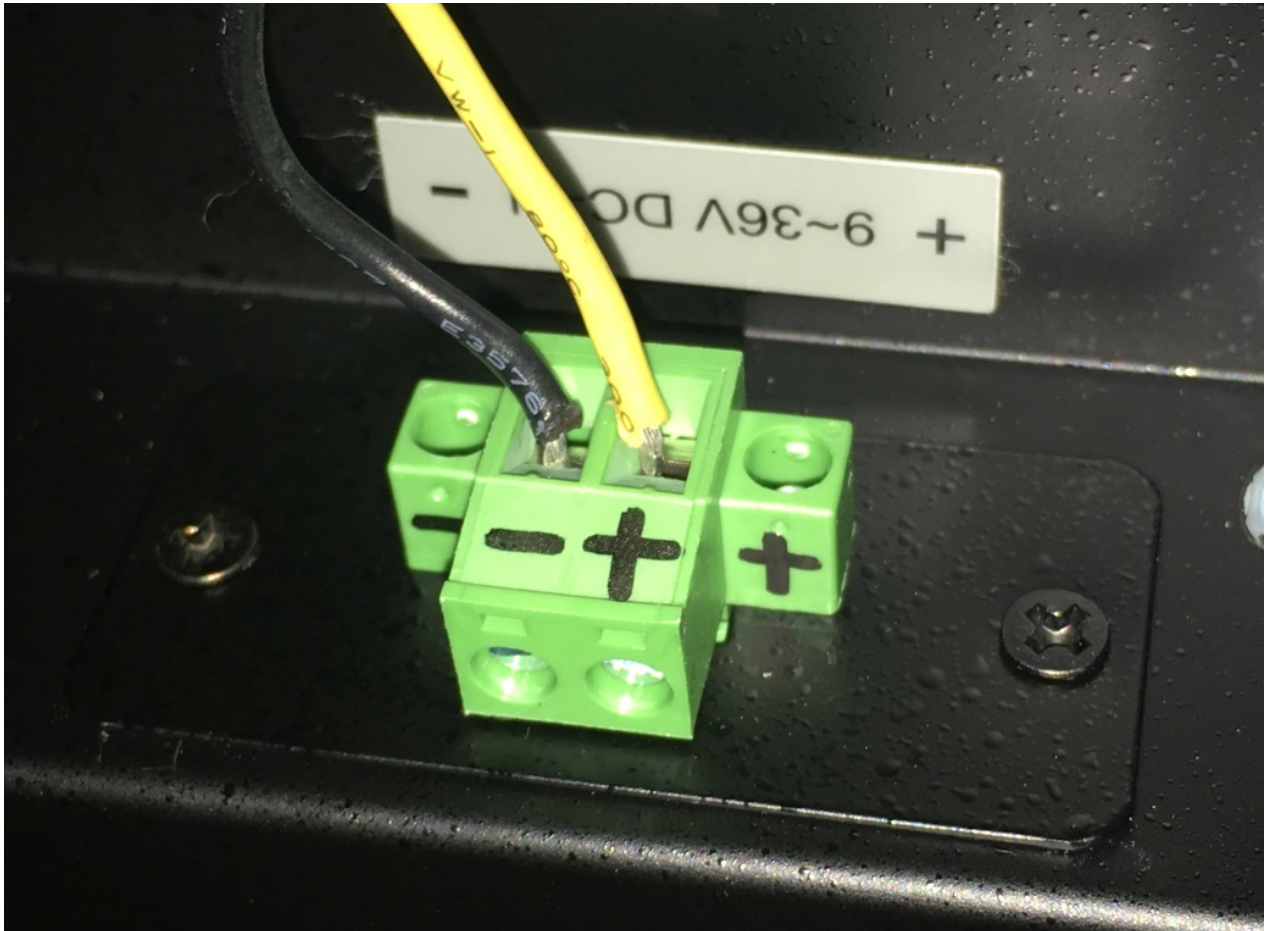



i-TECH COMPANY LLC

i-Tech Company LLC

TOLL FREE: (888) 483-2418 • EMAIL: info@itechlcd.com • WEB: www.iTechLCD.com

ETB42,ETB44 TERMINAL BLOCKS

1. FEATURES:

1-1 Special wire protector design to ensure reliable wires clamping

1-2 Capable of clamping a wide range of wire diameters.

1-3 The male connector of plug is mounted and soldered to the

1-4 The female socket using a twin leaf phosphor bronze contact mates with the male.

1-5 UL 94V-0 grade fire retardant engineering plastic used for the housing.

1-6 Good for insertion & withdrawal.

2. SPECIFICATIONS.

2-1 Specifications:

2-1-1 Rating: 10 Amp 300 VAC.

2-1-2 Dielectric strength: 2000 VAC Min. for 60 sec.

2-1-3 Insulation resistance: 500 M Ω Min. at 500 VDC.

2.2 MECHANICAL AND ENVIRONMENTAL

2-2-1 Temperature rating: -30°C to +80°C.

2-2-2 Wire range: 12 AWG to 24 AWG.

2-2-3 Torque: 5 kgf-cm. Max.

2-2-4 Pitch: 5.08 mm.

3. MATERIALS:

3-1 Housing: Polyamide 66 (UL 94V-0) resin.

3-2 Solder pin: Tin plated over Brass.

3-3 Screw: M3 x 0.5P, Chromatic Zinc plated over Steel.

3-4 Alignment Screw: M2.6 x 0.45P, Chromatic Zinc plated over Steel.

3-5 Wire Cage: Nickel plated over Zinc Alloy.

3-6 Wire protector: Nickel plated over Brass.



i-TECH COMPANY LLC

i-Tech Company LLC

TOLL FREE: (888) 483-2418 • EMAIL: info@itechlcd.com • WEB: www.iTechLCD.com

4. PART NUMBERING SYSTEM:

E T B 4 2 X X X X X X

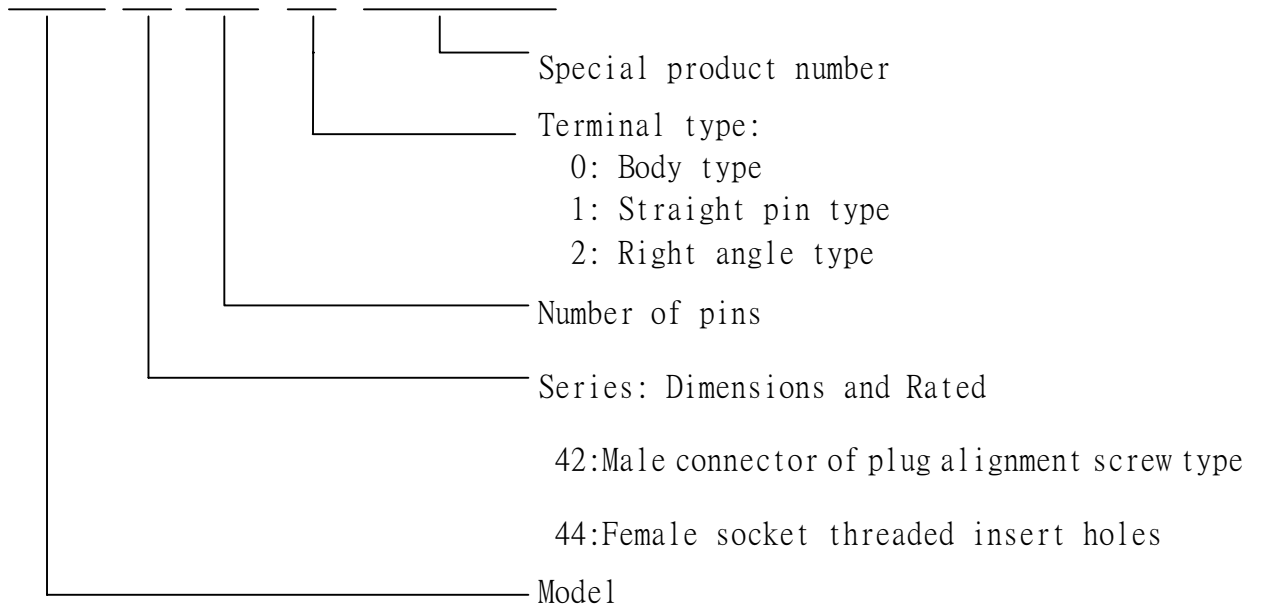

5. PACKING

5-1 PACKING METHOD

Terminal blocks are packed into plastic bags and then packed into boxes.

5-2 INFORMATION ON LABEL (stuck to each bag).

- | | |
|-------------------|-------------------------|
| (1) DESCRIPTION. | (8) DATE. |
| (2) LOT NO. | (9) MANUFACTURERS NAME. |
| (3) REPROCESS NO. | (10) ELECTRICAL. |
| (4) QUANTITY. | (11) RATING. |
| (5) TESTER NO. | (12) TEMPERATURE. |
| (6) ECE MARK. | (13) CONDUCTOR SIZE. |
| (7) QC STAMP. | (14) TORQUE. |

6. DRAWINGS:

Terminal block dimensions: see attached drawing

ETB42**0 SERIES DIMENSIONS

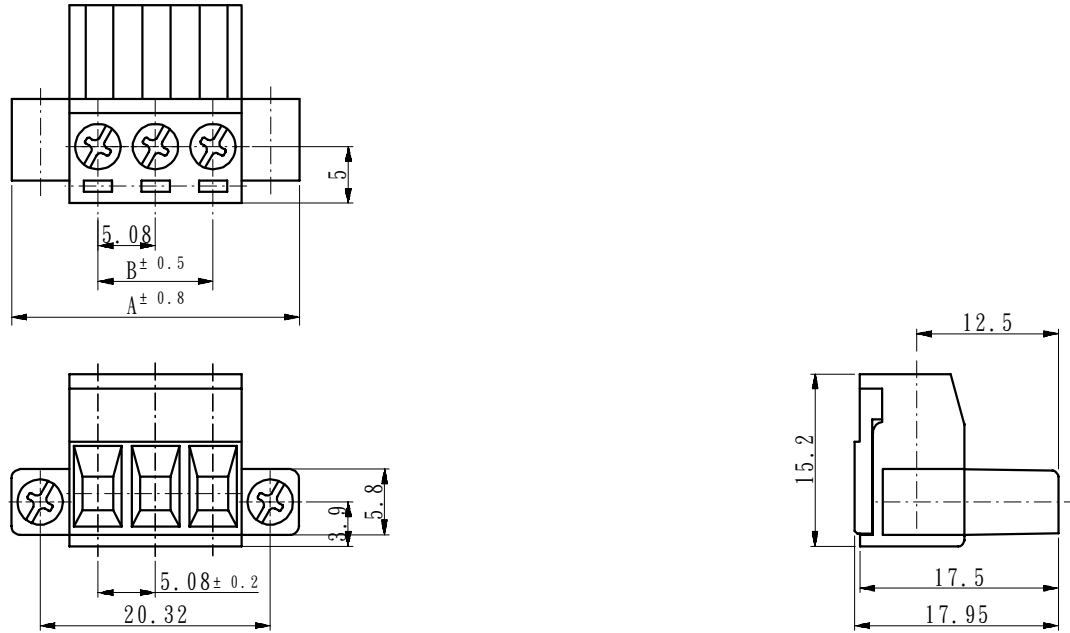

DIMENSIONS : PITCH:5.08mm(0.2inch) UNIT:mm(inch)

POLE	2	3	4	5	6	7	8	9	10	11	12	13	14	15	16	
A ± 0.8	20.32 (0.8)	25.4 (1.0)	30.48 (1.2)	35.56 (1.4)	40.64 (1.6)	45.72 (1.8)	50.8 (2.0)	55.88 (2.2)	60.96 (2.4)	66.04 (2.6)	71.12 (2.8)	76.2 (3.0)	81.28 (3.2)	86.36 (3.4)	91.44 (3.6)	
B ± 0.5	5.08 (0.2)	10.16 (0.4)	15.24 (0.6)	20.32 (0.8)	25.4 (1.0)	30.48 (1.2)	35.56 (1.4)	40.64 (1.6)	45.72 (1.8)	50.8 (2.0)	55.88 (2.2)	60.96 (2.4)	66.04 (2.6)	71.12 (2.8)	76.2 (3.0)	

				NORMAL TOLERANCE		PART NUMBER		ETB42**0*****				UNIT	MM (INCH)	PART NAME	ETB42
				RANGE	TOLERANCE	MATERIAL		-----				SCALE	1.5:1	TYPE	ETB42**0
				0 - 1	± 0.1							QUANTITY	-----	FILE NAME	ETB42000
				1 - 4	± 0.3							PROCESSING	-----	ASSEMBLY NUMBER	-----
				4 - 16	± 0.5							PROJECTION		SURFACE TREATMENT	-----
				16 - 63	± 0.8										
				63 - 250	± 1.0										
NO.	DETAILS	ALTERED BY	DATE			CHECK	GARY	DESIGN	LANCER	DRAWN	LANCER				