

Chassis Mount 10.1" Wide LCD Monitor 1024x600, LED-200nits, CF / SD / USB Plug and Play

Model: EDDW1010



FEATURES:

- Digital Signage LCD Frame
- Commercial Grade LCD with Metal housing
- CF / SD / USB Plug and Play
- High Definition Resolution 1024 x 600
- Max Resolution output 720P
- LED backlit
- Play Video/Photo/Music
- JPG,MP3,MPG1/2,AVI ,XVid
- Wide Viewing angle
- Auto-Play, Auto-repeat
- Support Timer to programming power on/off
- Support play list to specify files to play
- Support Programmable Photo Slide Timing
- Support Disconnection Memory to continuously play where it break
- Power Resume : Continue play the content from break point after power recover
- Power on password Setting
- Photo Rotation
- Full Function Remote Control
- Built in Speakers
- Optional High brightness 1000nits
- Optional Motion Sensors and Dimming Sensors
- Optional 6mm Vandal Proof Safety Glass
- Optional Stainless steel Front Bezel
- Optional Anti-Reflective AR 3mm Front Glass for protection



1. VGA Output Port
2. USB Plug-in
3. CF Plug-in
4. SD Card Plug-in



Plug-n-Play Solution

Custom Digital Signage In 3 Easy Steps!

No Internet Connection Required.



1. Save image or video file to USB

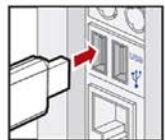

2. Plug USB/CF/ SD Card into player



3. Play on screen!



Metal Chassis/Housing for higher Impact protection. (Optional for Front AR Glass or Vandal Resistant glass)

Built In Speakers

Side OSD buttons can prevent unnecessary setting changes.

Auto Video Signal ON / OFF
Auto Always Power On

LCD SPECIFICATIONS:

Panel	Cell Type / Glass Surface	TFT LCD
	Aspect Ratio / Size	Wide / 10.1" viewable diagonal area
	Active Area / Pixel Pitch	222.72(H) x 125.28(V) mm / 0.2175(H) x 0.2088(V) mm
	Native Resolution / Colors	1024(H) x 600(V) / 262 K
	Brightness / Contrast	200 cd/m ² (typ) / 500 : 1
	Response Time	≤ 16 ms
	Viewing Angle (typical)	H. 90o (- 45o ~ + 45o) , V. 50o(- 30o ~ + 20o)
	Light Source	LED backlight, Long life, 35,000 hrs (typ)
Power	Internal power supply with universal / Auto-Sensing, AC 90 to 260V, 50 / 60 Hz	
Power Consumption	Operation / Power Saving	3 watt , < 1 watt (Support DPMS)
Operating Condition	Temperature / Humidity	0°C ~ 50°C (32°F ~ 122°F) , 10% ~ 90% (no condensation)
Storage Condition	Temperature / Humidity	- 20°C ~ 60°C (- 4°F ~ 140°F) , 10% ~ 90% (no condensation)
Certification		FCC , CE
Dimensions	Physical	W x H x D = 272.6 x 172.6 x 51 mm
	Carton	W x H x D = TBD
Weight	N.W. / G.W.	2 Kgs / 3 Kgs
Container Loaded	20ft / 40ft / 40ft HQ	TBD (Sets , By pallet)

Options	Touch	Video/TV	Enhanced Panel	Others
	Resistive touch	SV + AV	Panel with LED backlight	Digital Signage(Stand alone)
	Capacitive touch	SV + AV + AV_Looping	High brightness panel	Networking Digital Signage
	SAW touch	SV + AV + TV	Wide Temperature	Motion Sensor
	Infrared touch		Sunlight Readable	Light Sensor
	Protected glass			Auto-Dimming

MEDIA PLAYER SPECIFICATIONS:

Video Function	Input Format : 480P
	Output Format : 720P, SD Progressive, SD Interlace
	MPEG 111
	XViD
	AVI
Photo Function	JPEG photo playback
	JPEG minimum 16x16 pixels, Maximum 5120x3840 pixels
Audio Function	MP3 music playback
	AC3
Media Card Supported	CF, SD, USB drive
Convenient Features (By Remote Controller)	Auto-Play, Auto-repeat
	Support Timer to programming power on/off
	Support play list to specify files to play
	Support calendar
	Play/Pause , Stop
	Page up , Page Down

Picture Mode to Display



Play list setting



Preferences Setting



Time and Date



Timer setting to weekly turn on/off power



MECHANICAL DRAWINGS:

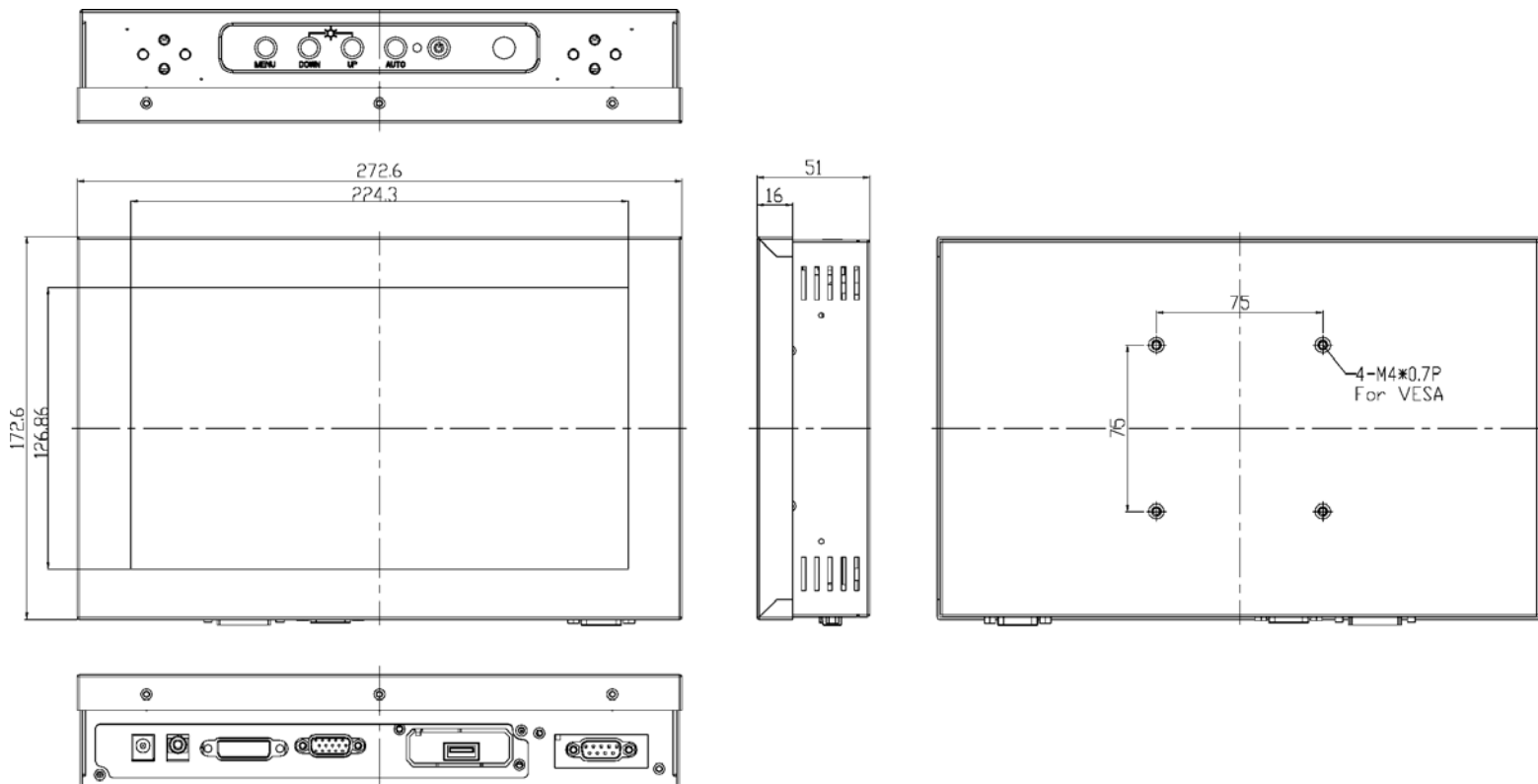

"These I/O are for references only, the actual power and video input might vary"



i-Tech Company LLC

TOLL FREE: (888) 483-2418 • EMAIL: info@iTechLCD.com • WEB: www.iTechLCD.com

"These high-definition LED Displays are simple to use and are purpose built for commercial environments"