



**Model: ESHS2850**

Stretch Display, Full IP66 (IP65 six sides), Stainless Chassis  
 28.5" LCD monitor, 1920x540, LED-500nits, VGA input, WV  
 178°/178°, (1/2 cut of 1920x1080)

**ESHS Series:** Industrial Chassis Wall/Surface Mount Stainless Steel LCD Monitor  
 (Optional Integrated Touch Screen/PC/ DC Input/Front NEMA4x/Front Stainless steel bezel and more...)

**Feature Highlights:**

- Water Proof Solution, Full IP NEMA4X Rating front and back
- Stainless Steel Housing Chassis Design
- AR Glass Protective Glass at front
- Optional High Brightness and Touch screen

- \* IP66 Water and Dust proof connection for a higher protection
- \* All Connectors are facing backward

## Features:

- Modular mechanism design provides flexible product configuration and easy maintenance.
- Optional with auto-brightness sensor offers application in day and night
- Optional to built-in PC eliminates external box

## Specification:

<b>Panel</b>	Cell Type	TFT LCD	
	Size	28.5" viewable diagonal area	
	Active Area / Pixel Pitch	698.4(H) x 196.42(V) mm / 0.363(H) x 0.363(V) mm	
	Native Resolution / Colors	1920(H) x 540(V) / 16.7 Million	
	Brightness / Contrast	500cd/m <sup>2</sup> (typ) / 5000 : 1	
	Response Time	≤ 9 ms	
	Viewing Angle (typical)	H. 176o (- 88o ~ + 88o) , V. 176o(- 88o ~ + 88o)	
	Light Source	LED Backlight, Long life, 50,000 hrs (typ)	
<b>Input Sources</b>	PC System	Signal	Analog RGB (0.7/1.0 V <sub>p-p</sub> , 75 ohms)
		Sync	Separate Sync, Composite Sync, Sync On Green
		Frequency	F <sub>h</sub> : 30 - 82Khz , F <sub>v</sub> : 50 -75Hz
	Audio System	2W Amplifier	
<b>Input Terminals</b>	1 x VGA (15 Pin Female D-Sub) , 1 x PC Audio (Stereo Headphone Jack) , 1 x DC Power Plug		
<b>Convenient Features</b>	Auto Calibration , Back Light Adjustment , Plug&Play (VESA DDC/CI, DDC 2B)		
	OSD Multi-Languages , Wall Mount Ready (VESA 100 x 100 mm)		
<b>Power</b>	External AC-to-12VDC power adapter with universal / Auto-Sensing, AC 90 to 260V, 50 / 60 Hz		
<b>Power Consumption</b>	Operation / Power Saving	30 watt , < 2 watt (Support DPMS)	
<b>Operating Condition</b>	Temperature / Humidity	0°C ~ 50°C (32°F ~ 122°F) , 10% ~ 90% (no condensation)	
<b>Storage Condition</b>	Temperature / Humidity	- 20°C ~ 60°C (- 4°F ~ 140°F) , 10% ~ 90% (no condensation)	
<b>Certification</b>		FCC , CE	
<b>Dimensions</b>	Physical	With Base(W x H x D) : TBD	
		Without Base(W x H x D) : 742.3 x 246 x 66 mm	
	Carton	W x H x D = TBD	
<b>Weight</b>	N.W. / G.W.	TBD	
<b>Container Loaded</b>	20ft / 40ft / 40ft HQ	816 / 1632 / NA (Sets , By pallet)	

<b>Options</b>	Video / TV	Others
	SV + AV	Digital Signage(Stand alone)
	SV + AV + AV Looping	Networking Digital Signage
	SV + AV + TV	Motion Sensor
		Light Sensor
		Auto-Dimming

Mechanical Drawing:

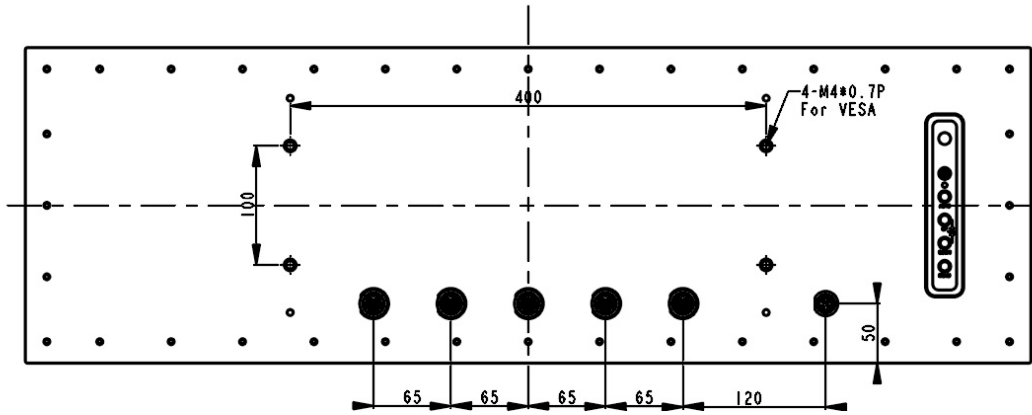
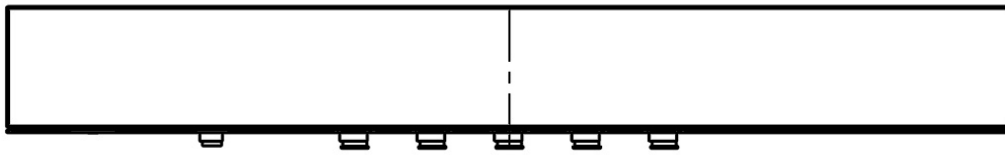
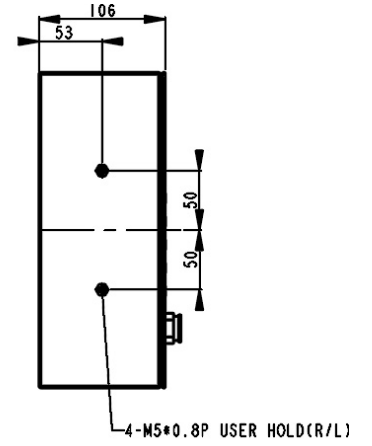
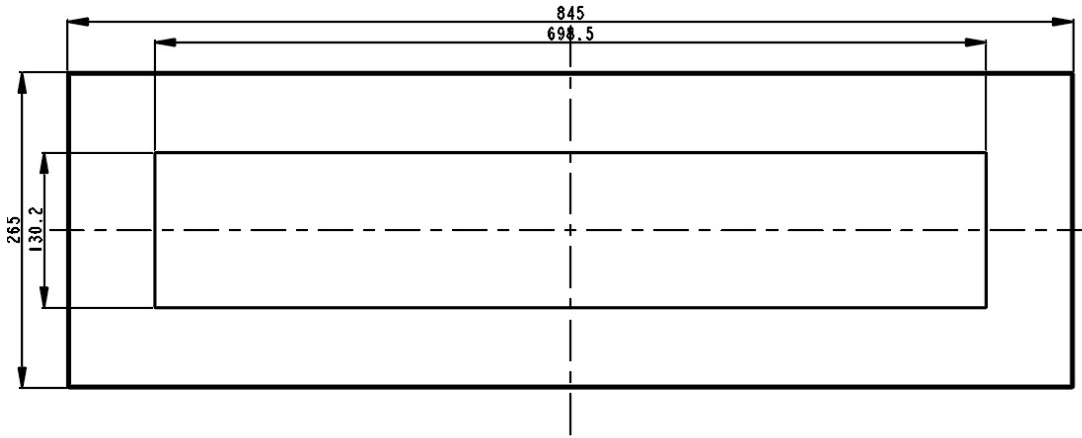

## LCD Options:



### LED Backlight Options

Introducing LED backlight options for monitors for energy efficiency and a brighter screen.



### VIDEO Input Options:

For Video inputs options:

DVI, DVI+HDMI, SVideo+AV, SVideo+AV+DVI, AV+Looping, DVI+AV+Looping, HD-SDI, BNC(PAL/NTSC)

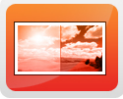

### Optical Bonding Options

- Optical Bonding provides the best reduction of ambient light washout of any commercially available enhancement technology.
- Optical Bonding has a lower cost than most other competing technologies.
- Optical Bonding offers superior ruggedization, enhancing the display durability under vibration, shock and other environmental extremes.



### RS-232 Remote Control Options

**Remote Control Protocol: Command Code to set system**



### 9-36V DC Input Options

iTech offers a selection of DC input from 9V to 36V



### Light Sensor and Motion Sensor Options

iTech LCD offers Light and Motion Sensor

### Privacy Filter

Front Glass Options:

- Anti Reflective AR Glass 3mm
- Anti Reflective AR Glass 6mm Vandal-Resistance
- Anti Reflective AR Glass 8mm Vandal-Resistance
- Anti Glare AG Glass 3mm