



Model: ESHS3790

Stretch Display, Full IP66 (IP65 six sides), Stainless Chassis
 37.9" LCD monitor, 1920x502, LED-500nits, VGA input, WV
 178°/178°, (1/2 cut of 1920x1080)



ESHS Series: Industrial Chassis Wall/Surface Mount Stainless Steel LCD Monitor
 (Optional Integrated Touch Screen/PC/ DC Input/Front NEMA4x/Front Stainless steel bezel and more...)

Feature Highlights:

- Water Proof Solution, Full IP NEMA4X Rating front and back
- Stainless Steel Housing Chassis Design
- AR Glass Protective Glass at front
- Optional High Brightness and Touch screen

- * IP66 Water and Dust proof connection for a higher protection
- * All Connectors are facing backward

Features:

- Modular mechanism design provides flexible product configuration and easy maintenance.
- Optional with auto-brightness sensor offers application in day and night
- Optional to built-in PC eliminates external box

Specification:

Panel	Cell Type / Glass Surface	TFT LCD / Black Anti-Glare, low reflection coating	
	Size	37.9" viewable diagonal area	
	Active Area / Pixel Pitch	930.24(H) x 243.219(V) mm / 0.4845(H) x 0.4845(V) mm	
	Native Resolution / Colors	1920(H) x 502(V) / 16.7 Million	
	Brightness / Contrast	500 cd/m ² (typ) / 1400 : 1	
	Response Time	≤ 5 ms(G to G)	
	Viewing Angle (typical)	H. 178o (- 89o ~ + 89o) , V. 178o(- 89o ~ + 89o)	
	Light Source	LED, Long life, 50,000 hrs (typ)	
Input Sources	PC System	Signal	Analog RGB (0.7/1.0 V _{p-p} , 75 ohms)
		Sync	Separate Sync, Composite Sync, Sync On Green
		Frequency	F _h : 30 - 82Khz , F _v : 50 -75Hz
	Audio System	3W speaker x 2	
Input Terminals	1 x VGA (15 Pin Female D-Sub) , 1 x PC Audio (Stereo Headphone Jack) , 1 x AC Inlet		
Convenient Features	Auto Calibration , Back Light Adjustment , Plug&Play (VESA DDC/CI, DDC 2B)		
	OSD Multi-Languages , Wall Mount Ready (VESA 400 x 200 mm)		
Power	Internal power supply with universal / Auto-Sensing, AC 90 to 260V, 50 / 60 Hz		
Power Consumption	Operation / Power Saving	100 watt , < 5 watt (Support DPMS)	
Operating Condition	Temperature / Humidity	0°C ~ 50°C (32°F ~ 122°F) , 10% ~ 90% (no condensation)	
Storage Condition	Temperature / Humidity	- 20°C ~ 60°C (- 4°F ~ 140°F) , 10% ~ 90% (no condensation)	
Certification	FCC , CE		
Dimensions	Physical	With Base(W x H x D) : TBD	
		Without Base(W x H x D) : 991.7 x 304.7 x 86.0 (mm)	
	Carton	W x H x D = TBD	
Weight	N.W. / G.W.	TBD	

Options	Video / TV	Others
	SV + AV	Digital Signage(Stand alone)
	SV + AV + AV Looping	Networking Digital Signage
	SV + AV + TV	Motion Sensor
		Light Sensor
		Auto-Dimming

Mechanical Drawing:

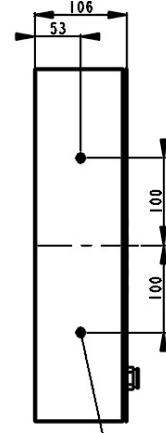
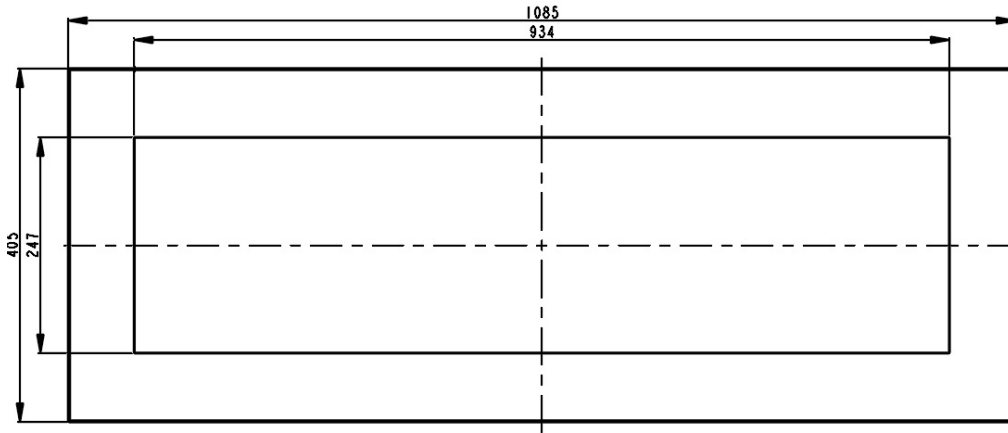

4-M5*0.8P USER HOLD(R/L)

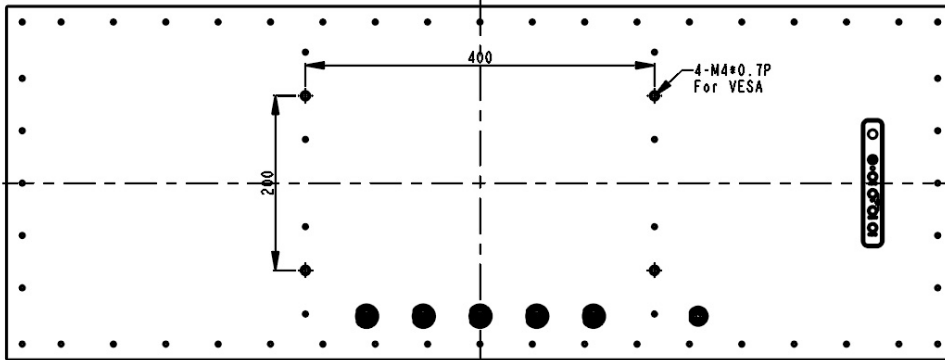
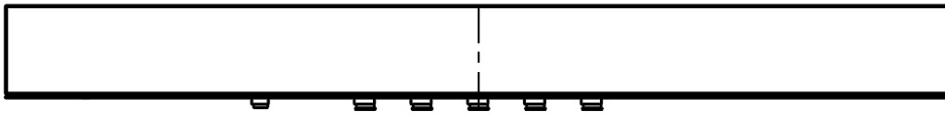

LCD Options:



LED Backlight Options

Introducing LED backlight options for monitors for energy efficiency and a brighter screen.



VIDEO Input Options:

For Video inputs options:

DVI, DVI+HDMI, SVideo+AV, SVideo+AV+DVI, AV+Looping, DVI+AV+Looping, HD-SDI, BNC(PAL/NTSC)

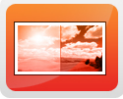

Optical Bonding Options

- Optical Bonding provides the best reduction of ambient light washout of any commercially available enhancement technology.
- Optical Bonding has a lower cost than most other competing technologies.
- Optical Bonding offers superior ruggedization, enhancing the display durability under vibration, shock and other environmental extremes.



RS-232 Remote Control Options

Remote Control Protocol: Command Code to set system



9-36V DC Input Options

iTech offers a selection of DC input from 9V to 36V

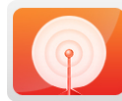

Light Sensor and Motion Sensor Options

iTech LCD offers Light and Motion Sensor

Privacy Filter

Front Glass Options:

- Anti Reflective AR Glass 3mm
- Anti Reflective AR Glass 6mm Vandal-Resistance
- Anti Reflective AR Glass 8mm Vandal-Resistance
- Anti Glare AG Glass 3mm