

IP64 Monitor

8" (4:3 Monitor) IP64 Water Proof

Resolution 1024 (W) x 768 (H), Brightness 250 cd/m2
Contrast Ratio 500:1, LCD color: 262K, Pixel Pitch (mm)
0.0675(H) x 0.2025 (V), Viewing Angle (H-V) 140°(H) / 120°(V)
(9) Backlight MTBF 20000hrs (LED backlight)

MODEL: MPM0800IP

FEATURES:

- 8 " LED Display
- Rugged Metal Housing
- Panel Mount Design
- Removable OSD Key Pad Option
- Optional Protective Glass
- Customized Design Acceptable
- Flexible Mechanical Designs for Industrial Applications
- Multi-signals: VGA, HDMI (Optional)
- Advanced OSD Control for Picture Quality Adjustment
- Projected Base Customized Designs Welcome

Custom Made:

You can choose some parts instead of a complete set. We will offer related accessories for your installation.

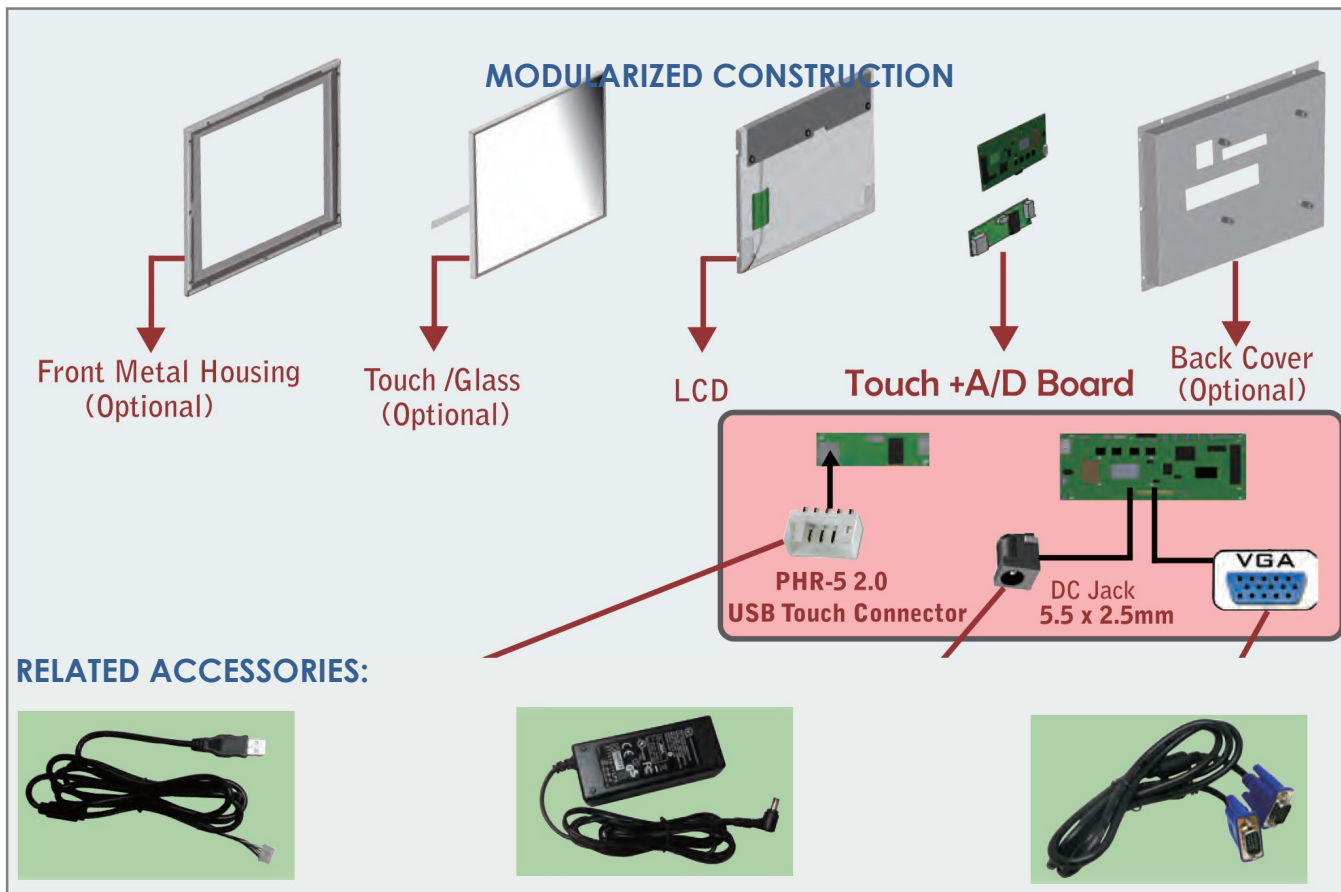

SPECIFICATIONS

LCD Spec	Size	8" (4:3)
	Resolution	800 x 600 (1024 x768 Option)
	Brightness(cd/m2)	250 cd/m2
	Contrast Ratio	500:1
	LCD color	262K
	Pixel Pitch (mm)	0.0675(H) x 0.2025(V)
	Viewing Angle(H-V)	140° (H) / 120° (V)
	Backlight MTBF	2000 hrs (LED backlight)
Connector	Video IN	VGA DSUB15-F / HDMI(Optional)
	Power	DC JACK 5.5*2.5 Standard
Environment	Operating Temp (°C)	-20°C ~ 60°C
	Storage Temp (°C)	-20°C ~ 80°C
	Humidity	10% to 95% (non-condensing)
Power	Power Supply	36W power adapter Input: 90VAC~264VAC, 50/60 Hz, Output: 12VDC
	Power Requirement	12 VDC
	Power Consumption	8W Max
Certification	IP Level	Front Panel IP 64
	Safety & EMC	CE / FCC

DRAWINGS

