

IP64 Touch Monitor

17" (4:3) Touch Monitor, IP64 Water Proof

Resolution 1280x1024, 5 Wire Resistive Touch Screen, Brightness 400 cd/m² Contrast Ratio 700:1, LCD color: 262K / 16.2M, Pixel Pitch (mm) 0.264(H) x 0.264 (V). Viewing Angle (H-V) 170°(H) / 165°(V) Backlight MTBF 50000hrs (LED backlight)

MODEL: MPM1700IP-TR

FEATURES:

- 17" LED Display
- Rugged Metal Housing
- Panel Mount Design
- 5-Wire Resistive Touch screen
- Removable OSD Key Pad Option
- Optional Protective Glass
- Customized Design Acceptable
- Flexible Mechanical Designs for Industrial Applications
- Multi-signals: VGA, HDMI (Optional)
- Advanced OSD Control for Picture Quality Adjustment
- Projected Base Customized Designs Welcome

Custom Made:

You can choose some parts instead of a complete set. We will offer related accessories for your installation.

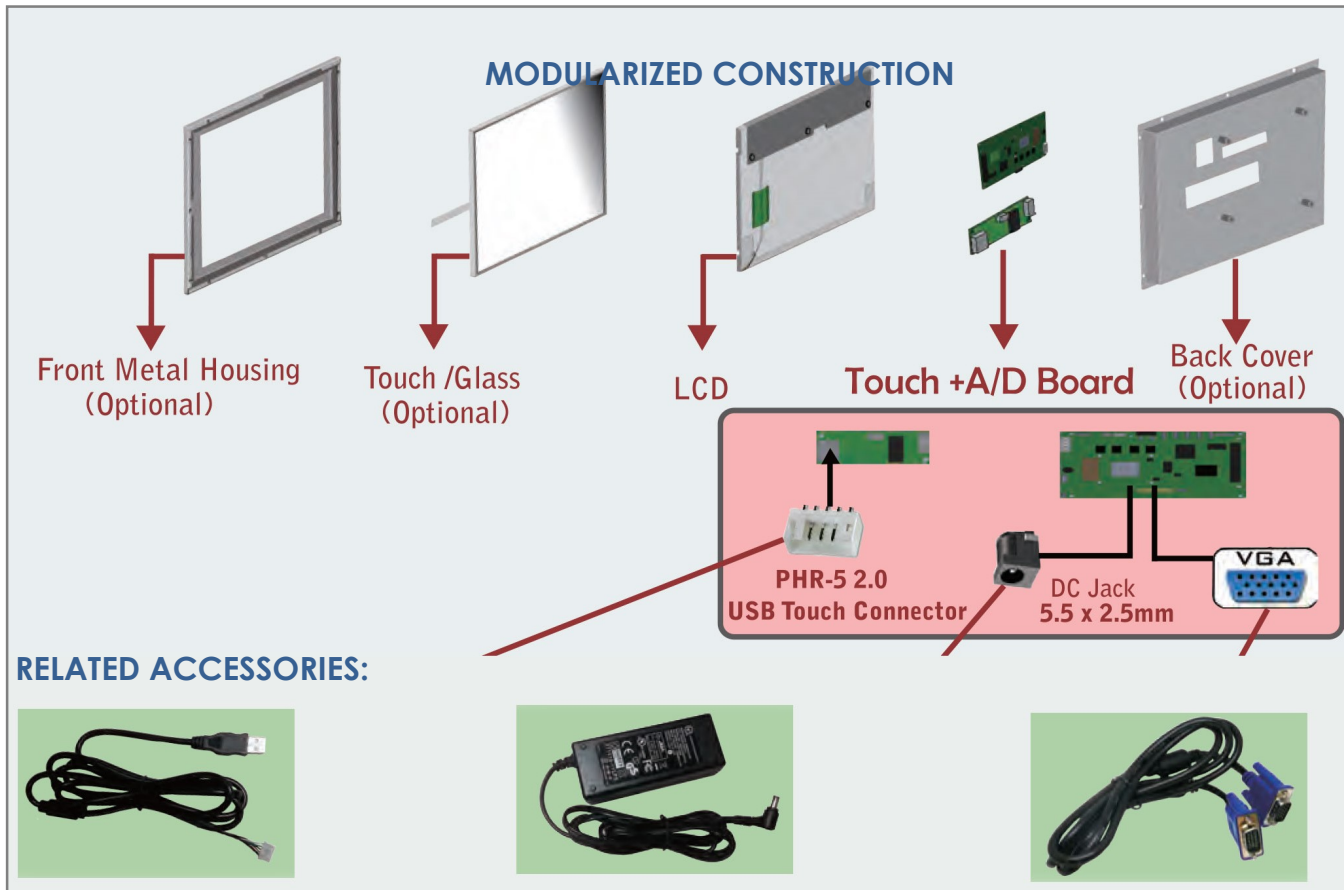

SPECIFICATIONS

LCD Spec	Size	17" (4:3)
	Resolution	1280 x 1024
	Brightness(cd/m2)	400 cd/m2
	Contrast Ratio	700:1
	LCD color	262K/16.2M
	Pixel Pitch (mm)	0.264(H) x 0.264(V)
	Viewing Angle(H-V)	170° (H) / 165° (V)
	Backlight MTBF	5000 hrs (LED backlight)
Touch	Touch Screen	5-wire resistive with USB Interface (PCAP Option)
	Touch Controller	EETI Touch Kit
Connector	Touch Connector	JST 2.0 5P / PHR-5
	Video IN	VGA DSUB15-F / HDMI(Optional)
	Power	DC JACK 5.5*2.5 Standard
Environment	Operating Temp (°C)	-20°C ~ 60°C
	Storage Temp (°C)	-20°C ~ 80°C
	Humidity	10% to 95% (non-condensing)
Power	Power Supply	36W power adapter Input: 90VAC~264VAC, 50/60 Hz, Output: 12VDC
	Power Requirement	12 VDC
	Power Consumption	15W Max
Certification	IP Level	Front Panel IP 64
	Safety & EMC	CE / FCC

DRAWINGS

